



APT LA 09

Preservation

in the city without limits . . .



APT LA 2009
NOVEMBER 2-6, 2009
MILLENNIUM BILTMORE HOTEL
LOS ANGELES



PRESERVATION IN THE CITY WITHOUT LIMITS



www.apti.org

WE'RE GLAD YOU'RE HERE!

As a Conference attendee you are experiencing APT's premier annual event for education and networking. We hope you'll plan your schedule so you can participate annually:

APT Denver 2010

Sheraton Denver Downtown Hotel
October 5–9, 2010
Denver, Colorado, USA

APT Victoria 2011

The Fairmont Empress
October 11–14, 2011
Victoria, British Columbia, Canada

APT Charleston 2012

Fall 2012
Charleston, South Carolina, USA

NEW THIS YEAR

Look for this symbol throughout the Program Book to identify events and opportunities that are value-added events.

NEW

Dine Around

NEW

University Alumni
Reunions

NEW

TRAILS OF LA

Trails of LA feature detailed trail maps for self-guided walking tours from the Millennium Biltmore Hotel to the Workshop/Symposium Dinner at Union Station, to the Awards Banquet at the Dorothy Chandler Pavilion and other cool, local places to hang out like little Tokyo and Chinatown. The maps include the Local Conference Committee's favorite places of interest, bars, clubs and restaurants...and a few surprises. Maps are available at the APT desk and for download from the APT Materials Distribution Center.

LOCAL CONFERENCE COMMITTEE

APT Western Chapter
Chairman—John Lesak
Program—John Fidler, Chris Gray, Bill Ellinger
Special Events—Jim McLane, Virginia Paca, Rosa Lowinger
Fundraising —Tom Neary, John Fidler
Marketing and Graphics —Stephanie Kingsnorth, Marlise Fratinardo
Outreach—Laura Janssen, Teresa Duff, Mark McMillan
Tours and Field Sessions—Peyton Hall, Glen Duncan, David Fixler

With collaboration and support from the Getty Conservation Institute.



The Getty Conservation Institute

CONTENTS

Conference Information	3
Agenda at a Glance.....	4
Conference Schedule	6
Monday.....	6
Tuesday	9
Wednesday	12
Thursday	18
Friday	25
Hotel Map	25
Student Scholarship Recipients.....	26
Sponsors	27
Exhibitors	30
APT Chapters Map.....	35
APT Denver 2010	Back Cover

CONFERENCE INFORMATION

GOING GREEN

APT has made choices that reduce the environmental impact of this Conference. Please do your part to support APT's efforts, including returning your name badge holder for future use.

In an attempt to reduce paper distributed on site, you will find Conference information available for download at the APT Conference Material Distribution Center and on line at www.aptconference.org.

APT STUDENT SCHOLARSHIPS AUCTION

Silent Auction—in Exhibit Hall

Live Auction—at Awards Banquet

See pages 7 and 9 for details.



TRANSPORTATION

We will use a combination of walking, the Metro and charter buses to reach off-site venues. Instructions and directions for each event are printed on your event tickets. Ambassadors will be available to direct you or accompany groups to each venue. If you are unable to walk, please inform the APT Registration and Information Desk.

AIA CREDITS

Workshops, Paper Sessions and Panel Discussions, Field Sessions and keynote addresses all qualify for AIA continuing education credits. CES forms are available at the APT Registration and Information Desk.



THE CYBER CAFÉ AND APT CONFERENCE MATERIAL DISTRIBUTION CENTER

The APT Conference Material Distribution Center is part of the Cyber Café located near the APT Registration and Information Desk. It includes Internet access to the APT LA 2009 Conference website and Conference material that can be reviewed, emailed to yourself or loaded on your own memory stick. You can also use your own computer to access the information on the APT Conference website at www.aptconference.org.

You will find:

- Program Book as a .pdf
- Participant list/Conference roster
- APT Student Scholarships Auction List
- Los Angeles city map
- More...check it out!



AGENDA AT A GLANCE

**All events are at the Millennium Biltmore Hotel unless otherwise noted.*

SUNDAY, NOVEMBER 1

3:00–6:00 pm	APT Registration and Information Desk	Galeria
--------------	---------------------------------------	---------

MONDAY, NOVEMBER 2

7:00 am–6:00 pm	APT Registration and Information Desk	Galeria
7:00 am–5:00 pm	Workshop: Injection Grouts	Meet at bus at hotel's Grand Avenue entrance
8:00 am–4:00 pm	Workshop: Architectural Ceramics	Roman
8:00 am–4:00 pm	Workshop: Advances in Seismic Retrofit	Mediterranean
8:00 am–4:00 pm	Symposium: Capturing the Past for Future Use	Gold
~5:15 pm	Start Trail to Union Station	Self-Guided Walk
6:00–9:00 pm	Workshop/Symposium Dinner with HABS Peterson Award Ceremony	Union Station

TUESDAY, NOVEMBER 3

6:30 am–6:00 pm	APT Registration and Information Desk	Galeria
6:45–8:15 am	AIA HABS Coordinating Committee Meeting	Heinsbergen
7:00 am–5:00 pm	Workshop: Injection Grouts	Meet at bus at hotel's Grand Avenue entrance
8:00 am–4:00 pm	APT Board of Directors Meeting and Lunch	Corinthian
8:00 am–4:00 pm	Workshop: Architectural Ceramics	Roman
8:00 am–4:00 pm	Workshop: Advances in Seismic Retrofit	Mediterranean
8:00 am–4:00 pm	Symposium: Capturing the Past for Future Use	Gold
8:45 am–Noon	Tour: Broadway—West	Meet at APT Desk
9:45 am–4:00 pm	Tour: Hurray for Hollywood	Meet at bus
12:45–4:00 pm	Tour: Millennium Biltmore Hotel	Meet in hotel lobby
3:45 pm	APT Student Scholars and Mentor Gathering	Meet at APT Desk
3:45 pm	Getty Foundation Guests and Hosts Gathering	Meet at APT Desk
4:00–5:30 pm	Opening Reception and Exhibits Grand Opening	Tiffany/Crystal
5:45–7:15 pm	Opening Session and Keynote Address	Emerald
7:30 pm	Chapters Mixer	Takami Sushi and Robata Bar
7:30 pm	Getty Foundation Guests and Hosts Dinner	Sai Sai Restaurant
7:30 pm	APT Technical Committee on Modern Heritage Reception	Meet in hotel lobby
Evening	Dinner on your Own	

WEDNESDAY, NOVEMBER 4

6:30 am–6:00 pm	APT Registration and Information Desk	Galeria
6:45–7:45 am	AIA HRC Breakfast Meeting	Cordoban
7:00–8:00 am	APT Committee: Development	Rendezvous Court
7:00–7:45 am	APT College of Fellows Business Meeting	Mediterranean

WEDNESDAY, NOVEMBER 4 (CONTINUED)

7:30–11:00 am	Bookstore and Exhibits	Tiffany/Crystal
7:30–10:30 am	Continental Breakfast	Exhibit Hall
8:00–10:00 am	Paper Sessions and Panel Discussions	Various rooms
10:30 am–12:30 pm	Paper Sessions	Various rooms
10:30 am–3:00 pm	Field Sessions	Meet at buses at hotel's Grand Avenue entrance
	Lunch on your Own	
1:30–4:30 pm	Sponge-Jet Demo	417 South Hill Street
3:00–5:00 pm	APT Technical Committee: Preservation Engineering, #1	Heinsbergen
5:15–7:00 pm	APT College of Fellows Reception and Lecture	Emerald
7:15 pm	Dine Around	Meet at APT Desk
7:00 pm	Columbia University GSAPP Alumni Gathering	Coles' French Dip Restaurant
7:30 pm	UPenn Alumni Gathering	The Crocker Club Restaurant

THURSDAY, NOVEMBER 5

7:00 am–6:00 pm	APT Registration and Information Desk	Galeria
8:00–9:00 am	Chapters and New Members Breakfast	Gold
8:00–9:00 am	APT Technical Committee: Sustainable Preservation	Cordoban
8:00–9:00 am	APT Technical Committee: Preservation Engineering, #2	Heinsbergen
8:00–9:00 am	APT Technical Committee: Modern Heritage	Mediterranean
8:00–9:00 am	APT Technical Committee: Codes for Historic Resources	Corsican
8:00–9:00 am	APT Committee: Student Scholarships	Rendezvous Court
8:00–9:00 am	APT Committee: Publications	Moroccan
8:00–9:00 am	APT Committee: Conferences	Rendezvous Court
8:00–9:00 am	APT Committee: Training & Education	Florentine
8:00–9:00 am	APT Committee: Outreach	Rendezvous Court
8:45–10:30 am	Continental Breakfast	Exhibit Hall
8:45 am–1:45 pm	Bookstore and Exhibits	Tiffany/Crystal
9:30–11:30 am	Paper Sessions and Panel Discussions	Various rooms
11:45–12:30 pm	Lunch with Exhibitors and Student Gathering	Biltmore Bowl
12:45–1:30 pm	APT Annual General Meeting	Biltmore Bowl
1:45–3:45 pm	Paper Sessions and Panel Discussions	Various rooms
4:00–5:00 pm	APT Board of Directors Meeting	Athenian
~5:15 pm	Start Trail to the Dorothy Chandler Pavilion	Self-Guided Walk
6:00–11:00 pm	APT Awards Banquet, COF Installation and Live Auction	Dorothy Chandler Pavilion

FRIDAY, NOVEMBER 6

7:00–9:00 am	APT Registration and Information Desk	Galeria
7:45 am–5:00 pm	Field Session: Missions—San Fernando and San Gabriel	Meet at APT Desk
7:45 am–7:00 pm	Field Session: Palm Springs	Meet at APT Desk

CONFERENCE SCHEDULE

SUNDAY, NOVEMBER 1

3:00–6:00 pm

APT Registration and Information Desk

Galeria

MONDAY, NOVEMBER 2

7:00 am–6:00 pm

APT Registration and Information Desk

Galeria

7:00 am–5:00 pm*

Injection Grouts for the Conservation of Architectural Surfaces [WS3] Meet bus at hotel's Grand Avenue entrance

Ticket: Required

Format: Lecture and hands-on demonstrations

Food: Continental breakfast (on the bus) and lunch (at Getty) are provided

Dress Code: Casual with closed-toe shoes (no sandals)

Transportation: Coach bus

*The bus will depart at 7:15 am. The class is scheduled for 8:30 am–3:30 pm.

Workshop Coordinators: Leslie Rainer and Elise Yakuboff, Getty Conservation Institute, Los Angeles, CA, USA

Hosted and organized by
The Getty Conservation
Institute



The Getty Conservation Institute

8:00 am–4:00 pm

Architectural Ceramics [WS1]

Roman

Ticket: Required

Format: Lecture and hands-on demonstrations

Food: Continental breakfast and lunch are provided

Dress Code: Casual

DINE AROUND—SIGN UP TODAY!

NEW

MIX AND MINGLE with other conference attendees by signing up to attend dinner after Wednesday evening's COF Lecture.

A member of the Local Conference Committee will host five to seven people at his/her favorite restaurant. Your host will accompany you to the restaurant and join you for dinner. Dutch treat (pay for your own order)

Sign up early at the APT Registration and Information Desk. Meet there immediately following the COF Lecture to depart as a group.

MONDAY, NOVEMBER 2 (CONTINUED)

Workshop Coordinators: Carolyn Searls, PE (CA), Simpson Gumpertz & Heger, Inc., San Francisco, CA, USA
Susan Knack-Brown, PE (MA), Simpson Gumpertz & Heger, Inc., Waltham, MA, USA
CeCe Louie, Architect (NY), Simpson Gumpertz & Heger, Inc., San Francisco, CA, USA

8:00 am–4:00 pm

Movin' and Shakin': Advances in Seismic Retrofit [WS2] Mediterranean

Ticket: Required

Format: Lecture and discussion

Food: Continental breakfast and lunch are provided

Dress Code: Casual

Workshop Coordinator: William W. Ellinger III, Architect (CA), Ellinger Architects & Associates, Pasadena, CA, USA

APT is grateful to the National Center for Preservation Technology and Training (NCPTT) for sponsoring this workshop.



8:00 am–4:00 pm

Capturing the Past for Future Use: Integrating Documentation with Repair, Design and Construction Practice in Historic Buildings [SY1] Gold

Ticket: Required

Format: Lecture, question-and-answer and discussion

Food: Continental breakfast and lunch are provided

Dress Code: Casual

Symposium Coordinators: Chris Gray, GBG-US Inc., Santa Monica, CA, USA

John Fidler, Simpson Gumpertz & Heger, Inc., Los Angeles, CA, USA

David Woodcock, FAIA, Texas A&M University, College Station, TX, USA

Presented in collaboration with the AIA Historic Resources Committee



THE AMERICAN INSTITUTE OF ARCHITECTS

Sponsored by General Services Administration



With collaboration and support from The Getty Conservation Institute



The Getty Conservation Institute

APT STUDENT SCHOLARSHIPS SILENT AUCTION

CHECK OUT the fabulous trips, items, books, services, and jewelry on display in the Exhibit Hall. All funds support the 13 Student Scholars participating in the Conference. The complete list is online at www.aptfconference.com.



MONDAY, NOVEMBER 2 (CONTINUED)

around 5:15 pm

NEW Trails of LA

Trail to Union Station

Ticket: Not required

Format: Self-guided walking tour

Distance: 1.5 miles

Estimated time: 40-80 minutes, depending on your pace

Stretch your legs and experience a few delights of historic downtown Los Angeles. This diverse trail will guide you through many layers of architectural history including the once thriving historic Broadway Theater and Bank Districts, the Civic Center, the original El Pueblo de Los Angeles and ends at Union Station, the gateway to western migration in the early 20th century and still a vital transportation mode today. The trail meanders through many important buildings including the Bradbury Building, past movie palaces, the Grand Central Market, the recently restored City Hall and Olvera Street. Who says nobody walks in LA?

After dinner at the Fred Harvey Restaurant, you may want to hop on the Metro gold line and get off at Chinatown, or take a short cab ride to Little Tokyo before heading back to the hotel.

6:00–9:00 pm

Workshop/Symposium

Union Station, Fred Harvey Room

Dinner with HABS Peterson

800 North Alameda St.

Award Ceremony

Ticket: Required

Format: Light reception followed by informal banquet and awards ceremony

Food: Drink, light hors d'oeuvres, dinner

Dress Code: Business casual

Transportation: Walk following the Trails of LA (above) or Metro

Directions: To get on the Metro, exit the hotel onto 5th Street (from the Galeria entrance) and turn right (heading east). Cross Olive Street. The Pershing Square stop is on the next corner, at 5th and Hill streets. Purchase your ticket at the bottom of the stairs (\$1.50 each way) and proceed through the turnstile. Follow signs for the Red Line east. Get off at the Union Station stop (two stops after Pershing Square). The Fred Harvey Room is off Union Station's main waiting room on the left as you enter from the Metro (south), in a separate building.

This event will serve two exciting purposes this year—an opportunity to network with other workshop and symposium participants and an occasion to celebrate the achievements of student work.

Continued...

MONDAY, NOVEMBER 2 (CONTINUED)

The Charles E. Peterson Awards for the best student record drawings submitted to the HABS Collection in the Library of Congress will be presented at this event. The jury is composed of representatives of the American Institute of Architects, the National Park Service, and the Athenaeum of Philadelphia, the trustee of the Peterson Endowment. The ceremony will include a selected showing of the winning projects and celebrate the winning teams and the faculty directors.

APT is grateful to Morley Builders and the Mollenhauer Group for sponsoring this dinner.



The Peterson Prize Ceremony is made possible through support of Marvin Windows and Doors.

TUESDAY, NOVEMBER 3

6:30 am–6:00 pm	APT Registration and Information Desk	Galeria
6:45–8:15 am	AIA-HABS Coordinating Committee Meeting	Heinsbergen
7:00 am–5:00 pm	<i>Injection Grouts for the Conservation of Architectural Surfaces, Day 2 [WS3]</i>	Meet bus at hotel's Grand Avenue entrance
	The bus will depart at 7:15 am. The class is scheduled for 8:30 am–3:30 pm.	
8:00 am–4:00 pm	APT Board of Directors Meeting and Lunch for 2008–2009 Members	Corinthian
8:00 am–4:00 pm	<i>Architectural Ceramics, Day 2 [WS1]</i>	Roman
8:00 am–4:00 pm	<i>Movin' and Shakin': Advances in Seismic Retrofit, Day 2 [WS2]</i>	Mediterranean

APT STUDENT SCHOLARSHIPS AUCTION

TAKE HOME a unique item by bidding at the Silent Auction in the Exhibit Hall and at the Live Auction at the Awards Banquet. Funds support the 13 Student Scholars from around the country who are giving short presentations and participating in the Conference.



TUESDAY, NOVEMBER 3 (CONTINUED)

8:00 am–4:00 pm	<p>Capturing the Past for Future Use: Integrating Documentation with Repair, Design and Construction Practice in Historic Buildings, Day 2 [SY1]</p>	Gold
8:45 am–Noon	<p>Tour: Broadway—West [T02] Ticket: Required Format: Guided walking tour Food: None Dress Code: Casual; wear good walking shoes Transportation: Walk; leaves hotel at 9:00 am</p> <p>Explore the social, cinematic, and architectural history of the largest National Register Historic Theatre District in the country.</p>	Meet at APT Desk
9:45 am–4:00 pm	<p>Tour: Hurray for Hollywood! [T01] Ticket: Required Format: Bus and walking tour Food: Lunch in Commissary Dress Code: Casual Transportation: Coach bus; leaves hotel at 10:00 am</p> <p>This is a special architectural historian’s tour of Fox Studios, one of Los Angeles’ historic working entertainment factories.</p>	Meet bus at hotel’s Grand Avenue entrance
12:45–4:00 pm	<p>Tour: Millennium Biltmore Hotel [T03] Ticket: Required Format: Guided walking tour Food: None Dress Code: Casual; wear good walking shoes Transportation: Walk; begins at 1:00 pm</p> <p>Explore the architecture and rich history of this magnificent hotel, known in its early days as “The Host of the Coast.”</p>	Lobby
3:45 pm	APT Student Scholars and Mentor Gathering	APT Desk
3:45 pm	Getty Foundation Guests and Hosts Gathering	APT Desk
4:00–5:30 pm	<p>Opening Reception and Exhibit Grand Opening Ticket: Required, but no charge Food: Drinks and appetizers (one comp drink included) Dress Code: Casual</p>	Exhibit Hall

TUESDAY, NOVEMBER 3 (CONTINUED)

5:45–7:15 pm

This session will be simultaneously interpreted from English to Spanish

Opening Session and Keynote Address

Emerald

Ticket: None required

Format: Lecture

Food: None

Dress Code: Casual

Preservation in an Age of Economic Challenge—More Necessary Than Ever

APT will celebrate the launch of the Annual Conference with tributes and recognitions. Keynote speaker, Kevin Starr, University Professor and Professor of History at the University of Southern California, will then discuss why the preservation of historic structures at a time of economic challenge, such as we are now experiencing, makes more than mere economic sense.

7:30 pm

Chapters Mixer

Takami Sushi and Robata Bar

Ticket: Not required 811 Wilshire Blvd, Suite 2100 Penthouse

Format: Social

Food: Dutch treat (pay for your own order)

Dress Code: Casual

Transportation: Walk .36 miles. Meet in the hotel lobby if you want to walk with a group.

Directions: Exit the hotel onto 5th Street (from the Galeria entrance) and turn left on 6th Street. Walk up 6th Street (west) to Flower Street and turn left. Turn right (west) on Wilshire Blvd. for one block. Takami is mid-block. Take the elevator to the penthouse.

Following the Keynote Address, everyone is invited to join APT Chapter members as they gather for dinner and/or drinks at this restaurant that floats 21 floors above downtown Los Angeles' Financial District. Described as one of the most unique restaurant concepts Southern California has ever experienced, Takami serves the highest quality sushi, robata, and Japanese-influenced entrees. Following dinner, you can enjoy unparalleled views of the LA area while enjoying a Signature cocktail.

7:30–10:30 pm

The Getty Foundation Guests and Hosts Dinner

Sai Sai Restaurant

Millennium Biltmore Hotel

Dinner for Getty Foundation Guests and their hosts. Meet in the Sai Sai Restaurant to enjoy a meal from La Bistecca Italian-style Steakhouse.

TUESDAY, NOVEMBER 3 (CONTINUED)

7:30 pm	<p>APT Technical Committee on Modern Heritage Reception Office of Kelly Sutherlin McLeod, 3827 Long Beach Blvd., Long Beach</p> <p>Members of APT's Technical Committee on Modern Heritage are invited to this social event. Meet in the hotel lobby to travel as a group via taxis. (Be prepared to split the fare with the others in your cab.)</p>
evening	Dinner on your Own

WEDNESDAY, NOVEMBER 4

6:30 am–6:00 pm	<p>APT Registration and Information Desk Galeria</p>
6:45–7:45 am	<p>AIA HRC Breakfast Meeting Cordoban</p> <p>Ticket: Required; purchase at APT Desk Format: Meal and program Food: Breakfast buffet Dress Code: Casual</p> <p>AIA members, and friends, attending the APT Conference, are encouraged to attend a program featuring Brenda Levin, FAIA, Levin & Associates Architects, as she presents, <i>Preserving the Architectural Icons of Los Angeles</i>. Co-hosted by AIA National Historic Resources Committee Advisory Group and Chair David Woodcock, and the local AIA/LA Chapter Historic Resources Committee, it will include a short AIA HRC business meeting. Cost, including buffet breakfast, is \$30 and tickets must be purchased by noon, Tuesday at the APT Registration and Information Desk.</p>
7:00–8:00 am	<p>APT Development Committee Meeting Rendezvous Court</p>
7:00–7:45 am	<p>APT College of Fellows Business Meeting Mediterranean Continental breakfast will be served in the meeting room.</p>
7:30–11:00 am	<p>Bookstore and Exhibits Tiffany/Crystal</p>
7:30–10:30 am	<p>Continental Breakfast Exhibit Hall</p>
8:00–10:00 am	<p>Paper Sessions and Panel Discussions All paper and panel sessions will be simultaneously interpreted from English to Spanish.</p>

DINE AROUND—SIGN UP FOR TONIGHT'S DINNER!

NEW **MIX AND MINGLE** with other conference attendees by signing up to attend dinner after tonight's COF Lecture. Choose your restaurant at the APT Registration and Information Desk.

Glazed Expressions—[CS01]

Heinsbergen

Track: Material Matters: Preservation of Historic Building Materials
Session Chair: Joe Sembrat, Conservation Solutions, Inc., Santa Fe, NM, USA

Conservation of Epoxy Dalle de Verre Panels (St Francis Chapel, Hawthorne, NY)

Dean Koga, Building Conservation Associates, New York, NY, USA; and Mariachiara Faliva, Thornton Tomasetti, New York, NY, USA

Wisdom with Sound and Light (Pyrex)

Mary Jablonski, Jablonski Building Conservation, New York, NY, USA

Unocal 76 Station

Andrea Morse, Sculpture Conservation Studio, Los Angeles, CA, USA

Modern Heritage—Progress, Priorities, Prognosis Panel Discussion—[CS02]

Emerald

Track: Preserving Modernism and Post-War Heritage
Moderator: David Fixler, FAIA, LEED AP, Einhorn, Yaffee, Prescott, Boston, MA, USA

Student Scholar Presentation: **Modernism in New Orleans: The Architecture of Albert Ledner**

Lindsay McCook, Columbia University, Richmond, VA, USA

Panelists: Tom Jester, AIA, QUINN EVANS | ARCHITECTS, Washington, DC, USA; Susan Macdonald, RIBA, Getty Conservation Institute, Los Angeles, CA, USA; and Theo Prudon, FAIA, Prudon and Partners, New York, NY, USA

Current and Emerging Methods of Evaluating Concrete Structures (With a focus on NDE and ASR)—[CS03]

Corinthian

Track: The Public Domain: Infrastructure of Urban and Suburban Landscapes
Session Chair: Tim Crowe, Wiss, Janney, Elstner Associates, Inc., Northbrook, IL, USA

Student Scholar Presentation: **A Comparative Study for the Determination of Deformation Behaviors of Building Materials of Modern Architecture by the Utilization of 3D Laser Scanner and Photo Shadow Moiré Technique**

Serra Akboy, Texas A&M University, College of Architecture, College Station, TX, USA

NDE and Schools

Edmund Meade PE (NJ), Robert Silman Associates, P.C., New York, NY, USA

Evaluation of Historic Concrete Structures Suffering from Alkali-Silica Reaction

Marjorie Lynch, Simpson Gumpertz and Heger Inc., New York, NY, USA; Jason Ideker, Oregon State University, Corvallis, OR, USA; and Anthony F. Bentivenga, Ph.D candidate, The University of Texas at Austin, Austin, TX, USA

Advances in Evaluation and Repair of Historic Concrete

Tanya Wattenburg Komars, PhD, California State University, Chico, CA, USA

Survey LA Panel Discussion—[CS04]

Roman

Track: LA Unconfidential: Lessons Learned in Preserving the World City

Moderator: Janet Hansen, Office of Historic Resources, City of Los Angeles, Los Angeles, CA, USA

Student Scholar Presentation: One-Way to Two-Way Street Conversions as a Preservation and Downtown Revitalization Tool: The Case Study of Upper King Street, Charleston, South Carolina

Meagan Baco, Clemson University and College of Charleston, Buffalo, NY, USA

Panelists:

Ken Bernstein, Department of City Planning, Office of Historic Resources, Los Angeles, CA, USA; Eva Sun, Department of City Planning, System and GIS Division, Los Angeles, CA, USA; and Rich Sucre, Page & Turnbull, San Francisco, CA, USA

10:00–10:30 pm

Refreshment Break

Exhibit Hall

10:30 am–12:30 pm

Paper Sessions

All paper sessions will be simultaneously interpreted from English to Spanish.

Ceramic Challenges—[CS05]

Heinsbergen

Track: Material Matters: Preservation of Historic Building Materials
Session Chair: Mary Hardy, Siegel & Strain Architects, Emeryville, CA, USA

Student Scholar Presentation: Development of Steel Cable Tensile Structures in the Post War Period

Tara Rasheed, Columbia University, New York, NY, USA

Wet Terra Cotta Buildings

Michael Edison, Edison Coatings, Inc., Plainville, CT, USA

Predicting Long-Term Durability of Terra Cotta and Clay Tile Roofing Based on the Physical Properties of Sampled Historic Materials

Susan Knack-Brown, PC (MA), Simpson Gumpertz & Heger, Inc., Waltham, MA, USA and Niklas Vigener, PE (CA, 8 others), Simpson Gumpertz & Heger, Inc., Rockville, MD, USA

Doulton Fountain, Glasgow

Nicola Ashurst, Adriel Consultancy, Edinburgh, United Kingdom

Challenging Typologies—[CS06]

Emerald

Track: Preserving Modernism and Post-War Heritage

Session Chair: Kelly Sutherlin McLeod, AIA, Kelly Sutherlin McLeod Architecture, Inc., Long Beach, CA, USA

Student Scholar Presentation: **Can it Float? Preserving Modern Merchant Ships**

Thomas Rinaldi, Columbia University, New York, NY, USA

SCSD: Forty Years Later (Schools)

Theodore Prudon, Columbia University/DOCOMOMO US, New York, NY, USA

Health and Heritage (Hospitals)

Cameron Logan, PhD, Faculty of Architecture, Building and Planning, University of Melbourne, Parkville, Victoria, Australia

Immeuble Clarté of Le Corbusier & Pierre Jeanneret 1932 — The Future is to Create

Carmen Reolon, Architecte EPFL/SIA, Switzerland, Marly, Switzerland and Jacques- Louis de Chambrier, architecte ETH/SIA, Geneva, Switzerland

Preserving Mies van der Rohe's Residences in the 21st Century

Christopher Enck, Klein and Hoffman, Inc., Chicago, IL, USA

10:30 am–3:00 pm

Field Sessions

Meet buses at hotel's Grand Avenue entrance

Ticket: Required

Format: Bus and walking tours (for which you should be in good physical condition)

Food: Lunch is provided

Dress Code: Casual, with comfortable walking shoes

Frank Lloyd Wright’s Textile Block [FS1]

Sold out

Preserving Pasadena’s Arroyo Seco Landmarks: the Gamble House & the Rose Bowl [FS2]

Mid-Century Modern Houses by Rudolf Schindler and Richard Neutra [FS3]

Sold out

10:30 am–5:00 pm

A Day at the Getty Conservation Institute [FS5]

Note new start time.

12:30 pm

Lunch on Your Own

A restaurant list is available at the APT Registration and Information Desk and from the hotel’s concierge.

1:30–4:30 pm

Product Demo: Sponge-Jet Cleaning on Granite and Other Sensitive Substrates Metro 417 Building, 417 S. Hill Street

Ticket: Not required

Format: Demonstration

Dress Code: Casual, with comfortable walking shoes

Transportation: Walk about two blocks

Directions: Exit the hotel onto 5th Street (from the Galeria entrance) and turn right (heading east). Walk one block to Hill Street, turn left and walk toward 4th Street. 417 S. Hill Street is at the end of the block on the left side of the street. Look for Sponge-Jet demonstration signage.

Visit the Subway Terminal Building, a quintessential part of 1920s Los Angeles, featuring granite and terracotta cladding, with bronze and aggregate concrete paved surfaces. Particular to the demonstration will be cleaning (1) lightly soiled granite pilasters, (2) heavily soiled carved granite corbels and (3) inset bronze letters with surrounding aggregate-finish concrete paving. Other substrates will also be available for inspection.

3:00–5:00 pm

APT Technical Committee: Preservation Engineering, #1 Heinsbergen

5:15-7:00 pm

College of Fellows Reception and Lecture Emerald

Ticket: Required

Format: Reception, followed by the Keynote Lecture

Dress Code: Casual

This session will be simultaneously interpreted from English to Spanish

“First Principles” in the Conservation of Asia’s Heritage: Lessons Learned from the UNESCO Asia-Pacific Heritage Conservation Awards Competition

Richard A. Engelhardt, UNESCO Charge de Mission, Senior Advisor to the UNESCO Assistant Director-General for Culture, and UNESCO Professor of Heritage Management will discuss how we balance the preservation of the unique heritage significance of our built environment with the transformations required by modernization and sustainable development.

With collaboration and support from the Getty Conservation Institute



The Getty Conservation Institute

In furthering its mission to advance knowledge of preservation technology among APT's members, the APT College of Fellows established in 1999 a lecture series that brings internationally known preservationists to APT's Annual Conferences.

The Getty Conservation Institute works internationally to advance conservation practice in the visual arts—broadly interpreted to include objects, collections, architecture, and sites. The Institute serves the conservation community through scientific research, education and training, model field projects, and the dissemination of the results of both its own work and the work of others in the field.

7:15 pm

NEW Dine Around

Galeria

Ticket: Not required

Format: Dinner with a small group; Dutch treat (pay for your own order)

Dress Code: Casual

Transportation: varies—walk to downtown locations; Metro or taxi to others

Sign up early to join your host, a member of the Local Conference Committee, and a few other Conference delegates at the host's favorite restaurant. You will be able to mix and mingle while enjoying a fabulous restaurant. Sign up early at the APT Registration and Information Desk. The restaurants will represent diverse cuisines, price points and locations. Look for your host holding a sign in the Galeria immediately following the COF Lecture. You will depart as a group. Metro fare is \$1.50 each way.

**APT STUDENT SCHOLARSHIPS AUCTION
PLACE A BID IN THE EXHIBIT HALL**



WEDNESDAY, NOVEMBER 4 (CONTINUED)

7:00 pm

NEW **Columbia University GSAPP Alumni and Friends Get-Together** Cole's French Dip,

Ticket: Not required 6th and Main streets

Format: Reception, bar

Dress Code: Casual

Transportation: Walk .5 mile

Directions: Exit the hotel onto 5th Street (from the Galeria entrance) and turn right (heading east). Turn right on Hill Street (heading south). Turn left on 6th Street (heading east) to Main Street. Cole's French Dip is located on the corner.

The Columbia University GSAPP welcomes alumni and friends to Cole's French Dip, creator of the **French Dip** sandwich. Cole's is the oldest Downtown Los Angeles restaurant and bar, and has been housed since 1908 in the hollow of the Pacific Electric Building, once the nucleus of the Pacific Electric Railway network. Cash bar and food. Contact person: Janet Foster, Columbia University

7:30–10:30 pm

NEW **PennDesign Alumni Gathering** The Crocker

Ticket: Not required Club, Mosler Lounge,

Format: Reception, bar 433 S. Spring Street

Dress Code: Business

Transportation: Walk .5 mile

Directions: Exit the hotel onto 5th Street (from the Galeria entrance) and turn right (heading east). Walk three blocks and turn left on Spring Street (heading north). The Crocker Club is located near the corner on the west side of Spring Street.

The University of Pennsylvania School of Design and Historic Preservation Program welcome alumni and friends to the Crocker Club for a unique evening inside the vault of the former Crocker Citizens National Bank building. Cash bar. Light fare will be served. Contact person: Amila Ferron, The Getty Conservation Institute

THURSDAY, NOVEMBER 5

7:00 am–6:00 pm

APT Registration and Information Desk Galeria

8:00–9:00 am

APT Chapters and New Members Breakfast Gold

Ticket: Required

Food: Breakfast

Dress Code: Casual

All APT Chapter members and New Members are invited to gather for breakfast to network and learn about chapter activities.

THURSDAY, NOVEMBER 5 (CONTINUED)

8:00–9:00 am

APT Committee Meetings

APT Technical Committee on Sustainable Preservation Cordoban
APT Technical Committee on Modern Heritage Mediterranean
APT Technical Committee on Preservation Heinsbergen
Engineering, #2
APT Technical Committee on Codes for Corsican
Historic Resources
APT Publications Committee Moroccan
APT Training & Education Committee Florentine
APT Student Scholarships Committee
APT Conferences Committee Rendezvous Court
APT Outreach Committee Rendezvous Court

8:45–10:30 am

Continental Breakfast

Exhibit Hall

APT is grateful to Historic Resources Group, LLC for sponsoring this breakfast.

HISTORIC RESOURCES GROUP

8:45 am–1:45 pm

Bookstore and Exhibits

Tiffany/Crystal

9:30–11:30 am

Paper Sessions and Panel Discussions

All paper and panel sessions will be simultaneously interpreted from English to Spanish.

Strange Surfaces—[CS07]

Heinsbergen

Track: Material Matters: Preservation of Historic Building Materials
Session Chair: Kim Rivera, Wiss, Janney, Elstner, Associates, Inc., Emeryville, CA, USA

Student Scholar Presentation: **Frank Lloyd Wright's**

Experimentation in Stucco Alenya Becker, Columbia University, New York, NY, USA

Restoration of Caen Stone Panels in Vanderbilt Hall, Grand Central Terminal

John Glavan, and Chris Gembinski, Building Conservation Associates, New York, NY, USA

Akoustolith Conservation

Laura Buchner and Claudia Kavenagh, Building Conservation Associates, New York, NY, USA

Brown Zinc Paint from the 1850s

Frank Welsh, Welsh Color & Conservation, Inc., Bryn Mawr, PA, USA

Curtain Walls/Glazing—[CS08]

Emerald

Track: Preserving Modernism and Post-War Heritage
Session Chair: Rick Flaster, Plant Construction, Mill Valley, CA, USA

Student Scholar Presentation A: **Tarnished Icon: Corrosion on Paul Cret's Tower at the University at Texas**

Emily Freeman, University of Texas at Austin, Austin, TX, USA

Student Scholar Presentation B: **Insulation**

Noel Weidner, School of the Art Institute of Chicago, Chicago, IL, USA

Making Modern Era Buildings More Efficient

Paul Totten, Simpson Gumpertz & Heger Inc., Rockville, MD, USA and Michael J. Heule, Helix Architecture + Design, Kansas City, MO, USA

Glass Wall Upgrade at Frank Lloyd Wright's Solomon R. Guggenheim Museum

Angel Ayon, LEED AP, WASA/Studio A, New York, NY, USA and William B. Rose, William B. Rose & Associates, Inc., Urbana, IL, USA

Energy Improvements at a Mid-century Modern Icon: Gund Hall at Harvard Graduate School of Design, Cambridge, Massachusetts

Henry Moss, Bruner/Cott & Associates, Concord, MA, USA

Recreation re-creation—[CS09]

Corinthian

Track: The Public Domain: Infrastructure of Urban and Suburban Landscapes

Session Chair: Frank Matero, School of Design, Philadelphia, PA, USA

Student Scholar Presentation: **New Insights Into Dolomitic Lime Mortar**

Jennifer Schork, Columbia University, New York, NY, USA

After the Fair: The Great Texaco Road Map at the New York State Pavilion

Frank Matero, School of Design, Philadelphia, PA, USA and Christine Conix, Conix Architects, Antwerp, Belgium

Playing with Art: Restoring Isamu Noguchi's Playscape Modernism

Donna Williams, Williams Art Conservation Inc., Los Angeles, CA, USA and Stephanie M. Hoagland, Jablonski Building Conservation, Inc., New York, NY, USA

Concrete, Glass and Science: Saving the New York Hall of Sciences

Ray Pepi, and Laura Buchner, Building Conservation Associates, New York, NY, USA

Murals Panel Discussion—[CS10]

Roman

Track: LA Unconfidential: Lessons Learned in Preserving the World City

Moderator: Leslie Rainer, Getty Conservation Institute, Los Angeles, CA, USA

Student Scholar Presentation: ***Cleaning Methods for the Removal of Limewash from Painted Plaster Surfaces: Utilizing Ion Exchange Resins on the Interior Architectural Finishes of the Capilla de Nuestra Señora del Rosario in Iglesia San José in San Juan, Puerto Rico***

Caitlin Smith, University of Pennsylvania, School of Design, Purcellville, VA, USA

Panelists: Pat Gomez, City of Los Angeles Department of Cultural Affairs, Los Angeles, CA, USA; Tom Learner, Getty Conservation Institute, Los Angeles, CA, USA; and Donna Williams and Chris Stavroudis, Williams Art Conservation, Inc., Los Angeles, CA, USA

11:45–12:30 pm

Lunch with Exhibitors and Student Gathering Biltmore Bowl

Ticket: Required

Format: Informal networking

Food: Lunch

Dress Code: Casual

Lunch tables will be labeled with numbers corresponding to exhibit booths (see page 30) at which suppliers will join you for lunch and conversation. This is also for students to meet members of the APT Board of Directors.

12:45–1:30 pm

APT Annual General Meeting

Biltmore Bowl

1:45–3:45 pm

Paper Sessions and Panel Discussions

All paper and panel sessions will be simultaneously interpreted from English to Spanish.

Adobe Achievements—[CS11]

Heinsbergen

Track: Material Matters: Preservation of Historic Building Materials

Session Chair: Kitty Vieth, Architectural Resources Group, San Francisco, CA, USA

Proterra Network and Conservation of Earthen Techniques and Buildings in Latin America

Marco Antonio Penido de Rezende, School of Architecture, Federal University of Minas Gerais, Brazil, Belo Horizonte, Brazil

Student Scholar Presentation: **Soft Capping: Bringing Sustainability to Masonry Ruins**

Alex Lim, University of Pennsylvania, Philadelphia, PA, USA

Exposed Earthen Architecture

Annick J. E. Daneels, National Autonomous University of Mexico, Mexico City, Mexico

The Stabilization and Conservation of Minaret Choli in Erbil, Iraq

Petr Justa, Gema Art Group,a.s., Prague, Czech Republic

Conserving Painted Plasters on a Seismically Compromised Adobe

Molly Lambert, Professional Associate, AIC, Architectural Conservation, Inc., Berkeley, CA, USA

Art and Sculpture—[CS12]

Emerald

Track: Preserving Modernism and Post-War Heritage

Session Chair: Mark McMillan, Wiss, Janney, Elstner, Associates, Inc., Emeryville, CA, USA

Student Scholar Presentation: **Caves for Men: The Preservation of Brutalist Interiors**

Susannah Ribstein, School of the Art Institute of Chicago, Chicago, IL, USA

Watts Tower

David Wessel, FAPT, AIC, and Katharine Untch, AIC, Architectural Resources Group, San Francisco, CA, USA

The Modern Plaza: Less is not Enough

Kenneth Itle, AIA, and Harry J. Hunderman, FAIA, FAPT, Wiss, Janney, Elstner Associates, Inc., Northbrook, IL, USA

A Moveable Feat: The Conservation of Sun and Moon Sculptures in the Hawaii State Capitol

Rosa Lowinger, Professional Associate, AIC, Rosa Lowinger and Associates, Los Angeles, CA, USA

Fire and Code—[CS13]

Corinthian

Track: The Public Domain: Infrastructure of Urban and Suburban Landscapes

Session Chair: Melisa Gaudreau, Page & Turnbull, Sacramento, CA, USA

Student Scholar Presentation: **The Early Phrygian Gate at Gordion, Turkey: An Investigation of Dry Stone Masonry in Seismic Regions and Recommendations for Stabilization**

Meredith Keller, University of Pennsylvania, Philadelphia, PA, USA

Code Harvesting

Paul Kapp, AIA, LEED AP, University of Illinois School of Architecture, Champaign, IL, USA

Designing for Fire

Jonathan Barnett, PE (MA and FL), PhD, FSFPE, Simpson Gumpertz & Heger, Inc., Waltham, MA, USA

The Effect of Fire Protection Gel on Building Materials

Jamie Morris, AIA, LEED AP, and Kimberly Steiner, Wiss, Janney, Elstner Associates, Northbrook, IL, USA

Fire Protection at Las Flores Adobe

Douglas Porter, School of Engineering, University of Vermont, Burlington, VT, USA and Nick Artim, Heritage Protection Group, Middlebury, VT, USA

Griffith Observatory Panel Discussion—[CS14] Roman

Track: LA Unconfidential: Lessons Learned in Preserving the World City

Moderator: Stephanie Kingsnorth, Pfeiffer Partners Architects, Inc., Los Angeles, CA, USA

Panelists: Carolyn Searls, PE, Simpson Gumpertz & Heger, Inc., San Francisco, CA, USA; Bob Knight, AIA, Drisko Studio Architects (formerly with Levin & Assoc.), Santa Monica, CA, USA; and Steven Hall, AIA, Pfeiffer Partners Architects, Inc., San Francisco, CA, USA

4:00–5:00 pm

APT Board of Directors Meeting for 2009–2010 Members

Athenian

around 5:15 pm

NEW Trails of LA

Trail to LA Music Center

Ticket: Not required

Format: Self-guided walking tour

Distance: .75 miles

Estimated time: 30–45 minutes, depending on your walking/looking pace

This trail takes you from the Historic Core through some of the most modern civic buildings in Los Angeles, including Frank Gehry's Disney Concert Hall, Los Angeles Public Library, Colburn School of Music, and California Plaza. There is a fairly steep grade for the first block and a half, but after that it will take you through an intimate series of plazas, courtyards and gardens filled with water features and dramatic vistas. The return trip is different and it is all downhill.

6:00–11:00 pm

APT Awards Banquet, COF Installation and Auction Dorothy Chandler Pavilion at the Music Center

Ticket: Required 135 North Grand Avenue

Format: Reception followed by banquet and awards ceremony

Food: Drink, light hors d'oeuvres, dinner (one comp drink included)

Dress Code: Dinner (jacket, but not tux)

Transportation: Walk five blocks (direct) or .75 miles (via Trails of LA) or taxi

Directions: If you're not following the Trails of LA (above), you can take a direct route to the Dorothy Chandler Pavilion. Exit the hotel onto 5th Street (from the Galeria entrance) and turn left. Turn right on Grand Avenue (heading north). Go five blocks to 1st Street (past Walt Disney Concert Hall). The Music Center is on the left. The entrance to the Dorothy Chandler Pavilion is past the Center and up the outdoor stairs into the plaza. Turn left at the top of the stairs.

If walking is not an option for you, please inform the staff at the APT Registration and Information Desk.

APT will relive the splendor of one of the past Academy Awards venues as we celebrate and dine in the Grand Hall of the Dorothy Chandler Pavilion. The evening will include this year's APT College of Fellows installation ceremony; presentation of APT's awards—the President's Awards, the Publications Awards, the Martin Weaver Award, the Oliver Fuller Torrey Award, and the Anne de Fort Menares Award; introduction of the 2009 Student Scholars; and the Student Scholars Live Auction.

RICHARD NEUTRA, ARCHITECT: SKETCHES AND DRAWINGS

THE EXHIBIT, RICHARD NEUTRA, ARCHITECT: Sketches and Drawings, can be seen this week at Los Angeles Public Library's Central Library, located next door to the Biltmore Hotel at 630 W. 5th Street. The exhibit has been extended specifically for APT LA 2009 Conference attendees. Exhibit hours are 10:00 am–8:00 pm, Monday–Thursday; 10:00 am–6:00 pm, Friday and Saturday; 1:00–5:00 pm, Sunday. The exhibit is accompanied by a free audio tour.

The exhibit is an outstanding selection of travel sketches, figure drawings and building renderings by one of modernism's most important architects, Richard Neutra, and features pieces that range from early pencil sketches to later pastel renderings.

FRIDAY, NOVEMBER 6

7:00–9:00 am

APT Registration and Information Desk

Galeria

7:45 am–5:00 pm

Field Session Meet bus at hotel's Grand Avenue entrance

Missions—San Fernando and San Gabriel [FS6]

Ticket: Required

Format: Bus and walking tour

Food: Continental breakfast, lunch and snacks are provided

Dress Code: Casual, with good walking shoes

7:45 am–7:00 pm

Field Session Meet bus at hotel's Grand Avenue entrance

The Desert Bloomed—Palm Springs in the 20th Century [FS7]

Ticket: Required

Format: Bus and walking tour

Food: Continental breakfast, lunch and snacks are provided

Dress Code: Casual, with good walking shoes

HOTEL MAP

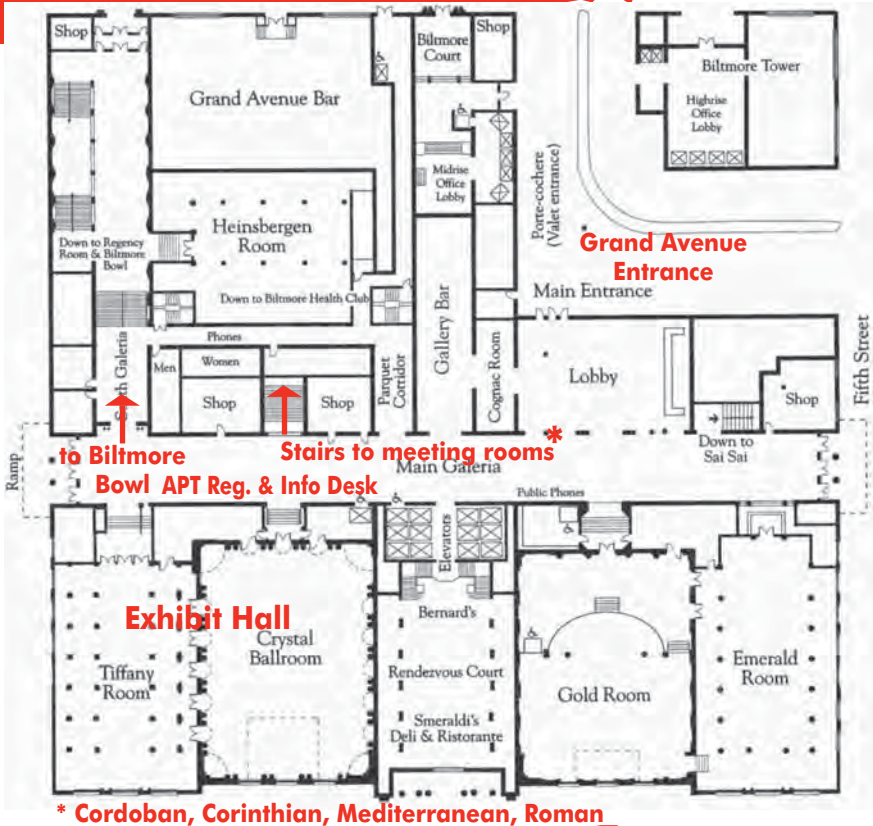

STUDENT SCHOLARSHIP RECIPIENTS

SERRA AKBOY

A Comparative Study for the Determination of Deformation Behaviors of Building Materials of Modern Architecture by the Utilization of 3D Laser Scanner and Photo Shadow Moiré Technique

Texas A&M University, College of Architecture, College Station, TX

MEAGAN BACO

One-Way to Two-Way Street Conversions as a Preservation and Downtown Revitalization Tool: The Case Study of Upper King Street, Charleston, South Carolina

Clemson University and College of Charleston, Charleston, SC

ALENYA BECKER

Frank Lloyd Wright's Experimentations in Stucco
Columbia University, New York, NY

EMILY FREEMAN

A Tarnished Icon: Corrosion on Paul Cret's Tower at the University at Texas

University of Texas at Austin, Austin, TX

MEREDITH KELLER

The Early Phrygian Gate at Gordion, Turkey: An Investigation of Dry Stone Masonry in Seismic Regions and Recommendations for Stabilization

University of Pennsylvania, Philadelphia, PA

ALEX LIM

Soft Capping: Bringing Sustainability to Masonry Ruins

University of Pennsylvania, Philadelphia, PA

TARA RASHEED

Development of Steel Cable Tensile Structures in the Post War Period

Columbia University, New York, NY

SUSANNAH RIBSTEIN

Caves for Men: The Preservation of Brutalist Interiors

School of the Art Institute of Chicago, Chicago, IL

THOMAS RINALDI

Can it Float? Preserving Modern Merchant Ships
Columbia University, New York, NY

JENNIFER SCHORK

New Insights Into Dolomitic Lime Mortar
Columbia University, New York, NY

CAITLIN SMITH

Cleaning Methods for the Removal of Limewash from Painted Plaster Surfaces: Utilizing Ion Exchange Resins on the Interior Architectural Finishes of the Capilla de Nuestra Señora del Rosario in Iglesia San José in San Juan, Puerto Rico

University of Pennsylvania, Philadelphia, PA

NOEL WEIDNER

Insulation
School of the Art Institute of Chicago, Chicago, IL

MARTIN WEAVER STUDENT SCHOLAR 2009

LINDSAY MCCOOK

Modernism in New Orleans: The Architecture of Albert Ledner

Columbia University, New York, NY

Ms. McCook was chosen from among the 13 APT Scholarship finalists as the Martin Weaver Student Scholar. The scholarship is not visualized as a prize for past accomplishments, but rather to support innovative and current research in the field of Historic Preservation. The grant is intended to promote the continued advancement of research and a career in historic preservation in the early stages of a young professional. Ms. McCook will use her scholarship to research Albert Ledner buildings in and around the New Orleans area.

SPONSORS

APT is grateful for the financial and in-kind support of each of our sponsors and exhibitors. Following is a list of those who had contributed by October 1:

★ **Gold Star Sponsors are companies and individuals who have committed to sponsoring three consecutive APT Conferences.**

STUDENT SCHOLARSHIPS

APT-DC Chapter
APT Northeast Chapter
APT Rocky Mountain Chapter
APT Western Chapter
Brick NY

IN KIND DONATIONS

AIA HRC—American Institute
of Architects Historic Resources
Committee (AIA HRC)
The Getty Conservation Institute
LA Conservancy
Robert Silman Associates

FRIEND OF THE CONFERENCE—\$500

Atkinson-Noland & Associates, Inc.
Bahr, Vermeer & Haecker (BVH)
Architects
Joan Berkowitz ★
California Office of Historic
Preservation
Goucher College, Master of Arts in
Historic Preservation
Karin Link (Thomas Street History
Services)
Keast & Hood Co.
Landmark Facilities Group, Inc.

Lord, Aeck & Sargent
Master Group
Michigan Ornamental Metals
Gretchen Pfahler
Preventive Maintenance
Inspections, Inc.
Mark Rabinowitz
Brian Scott Robinson
Simpson, Gumpertz & Heger Inc.,
Design + Consulting
Engineers ★
Structural Focus

CONFERENCE SUPPORTER— \$1,000

Cambridge CM, Inc.
Cintec North America ★
Evergreene Architectural Arts, Inc.
EYP/Einhorn Yaffee Prescott,
Architecture & Engineering P.C.
GB Geotechnics USA Inc.
The Gilders' Studio
Jablonski Building Conservation
Klein and Hoffman, Inc.
Masonry Solutions International,
Inc.
Nicholson & Galloway, Inc.
Pfeiffer Partners Architects, Inc.
Quimby McCoy Preservation
Architecture
Restore Media, LLC
Wiss, Janney, Elstner Associates,
Inc.

CONFERENCE SPONSOR—
\$2,500

Allen
Architectural Metals INC.

 **apollobbc**
Better Building Consultants

 **Boston Valley**
Terra Cotta

BRICK
INDUSTRY

Associated Brick Mason Contractors of
Greater New York

New York/New Jersey Council of the
Brick Industry Association

Barbara A. Campagna,
FAIA, LEED AP ★

CHRISTMAN
SINCE 1894

 *Edison Coatings, Inc.*

JOHN A. FIDLER, RIBA Assoc
AIA IHBC FRICS FAPT

 **GLADDING, McBEAN**

HISTORIC RESOURCES GROUP

MOLLENHAUER

MORLEY
BUILDERS

NCPTT
NATIONAL CENTER
FOR PRESERVATION
TECHNOLOGY
& TRAINING ★

PAGE & TURNBULL
Architecture · Historic Preservation · Urban Planning
San Francisco · Sacramento · Los Angeles · www.page-turnbull.com

SHAWS
TERRACOTTA
SINCE
1897

Handcrafted in Lancashire, England

 **SPECTRA COMPANY**

WeRestoreBuildings.com

CONFERENCE PARTNER—\$5,000



ALTERNATE CONSTRUCTION CONCEPTS
INNOVATIVE SOLUTIONS FOR EVERY CHALLENGE

**Plan B
Engineering**



fine art and architecture publishing



**BALCONY
MEDIA, INC.**

CONFERENCE BENEFACTOR—\$10,000

GSA

General Services Administration

CONFERENCE PARTNER—\$20,000+



The Getty Foundation

The Getty Conservation Institute

EXHIBITORS

20th Century Fox Studios Staff Shop

Booth #22

www.foxstudios.com
Shari Schroder, Executive Director,
Marketing
310-369-4636
foxinfo@fox.com
Custom architectural molds (restoration
and duplication).

AIA Los Angeles Historic Resources Committee

Booth #20

www.aialosangeles.org
Brian D. Bartholomew, AIA
213-236-2550
barthobde@strinc.com
Promotes the role of the Los Angeles-
area historic architect within the
profession through the development of
information and knowledge.

AIC (American Institute for Conservation of Historic and Artistic Works), Architecture Specialty Group

Booth #33

www.aic-faic.org
Ruth Seyler, Membership and Meetings
Director
202-452-9545
rseyler@aic-faic.org
Association of art and historic
conservators.

Allen Architectural Metals, Inc.

Booth #08

SPONSOR

www.allenmetals.com
Kate Allen, VP Sales and Operations
347-232-4146
kate@allenmetals.com
Custom fabrication with strong
emphasis on design, preservation and
replication of cast metals.

Alternate Construction Concepts

Booth #14

SPONSOR

www.alternateconstructionconcepts.com
Ivar Galilea, Senior Project Executive
610-349-2668
ivarg@alternateconstructionconcepts.
com
A turn key stabilization contractor
specializing in temporary shoring and
bracing systems for historic structures.

Apollo BBC

Booth #23

SPONSOR

www.apollobbc.com
Gordon Shepperd, Principal
713-869-0000
gshepperd@apollobbc.com
Commissioning, energy analysis,
mechanical HVAC, enclosure consulting
and testing, structural engineering,
building evaluation.

APT / Association for Preservation Technology International

Booth #41

www.apti.org
Nathela Chatara, Administrative
Director
217-529-9039
info@apti.org
A cross-disciplinary, membership
organization dedicated to promoting
the best technology for conserving
historic structures and their settings.

APT Endowment Campaign

Booth #40

www.apti.org
217-529-9039

Walker Johnson, Committee Co-Chair
wjohnson@jlarchitects.com

Harry Hunderman, Committee Co-Chair

hhunderman@wje.com

The fundraising arm of the Association for Preservation Technology International.

Architectural Photography & Design

Booth #10

www.ArchPhotoDesign.com

Richard Levy, AIA, APA, Owner
213-250-0100

RLevy@ArchPhotoDesign.com

Photographer of architecture, interiors, construction progress, historic preservation and fine art.

Arte Mundit® by FTB-Remmers

Booth #09

www.artemundit.us

Filip Moens, CEO
(+32) 14 84 8080

filip.moens@ftbremmers.com

Peelable latex for interior cleaning of stone, brick, terracotta, concrete, plaster or marble.

Balcony Press/Form Magazine

Booth #32

www.balconypress.com

Joe Cloninger
818-551-1073

joe@formmag.net

Balcony Media publishes art and architecture books under the Balcony Press imprint and FORM: pioneering design magazine.

Cathedral Stone Products, Inc.

Booth #13

www.cathedralstone.com

Gary Keshner, Marketing & Sales Coordinator

410-782-9150

mstlong@aol.com

Masonry restoration products: Jahn Restoration Mortars, cleaners, silicate paints and acid-free strippers.

Cintec North America

Booth #07

SPONSOR

www.cintec.com

Mike Ferrell, North America General Manager

410-212-1533

mferrell@cintec.com

Structural anchor supplier for CMU.

Donhead Publishing Ltd.

Booth #18 and 24

www.donhead.com

Jill Pearce, Managing Editor
+44 1747828422

jillpearce@donhead.com

Practical books for professionals on building conservation.

Edison Coatings

Booth #38

SPONSOR

www.edisoncoatings.com

Mike Edison, Owner

800-697-8055

edison@edisoncoatings.com

Manufacturer of custom masonry repair and coating products and Rosendale natural cement.

**Flickinger Glassworks
Booth #16**

www.flickingerglassworks.com
Charles Flickinger, Owner
646-270-2183
CFF7@aol.com

Specializing in quality bent glass for architectural and lighting applications. Also represented is Historical Arts and Casting, artisans specializing in the restoration and replication of architectural cast metal ornament.

**General Services Administration
(GSA)
Booth #26**



www.gsa.gov
Caroline Alderson, Historic Building Program Manager
202-501-9156

caroline.alderson@gsa.gov
Provides strategic and technical guidance to promote viability, reuse, and integrity of 470 historic buildings that provide workspace for more than 100 federal agencies.

**The Getty Conservation Institute
Booth #31**



www.getty.edu
Anna Zagorski, Research Associate
310-440-6243
Azagorski@getty.edu

The Getty Conservation Institute works internationally to advance conservation practice in the visual arts through scientific research, education and training, model field projects, and the dissemination of the results of both its own work and the work of others in the field.

**Gladding, McBean Company
Booth #19**



www.gladdingmcbear.com
Bill Padavona, General Manager
916-644-9301
Bill.Padavona@paccoast.com
Manufacturer of architectural terra cotta, clay roof tile, clay floor tile, and ceramic pottery.

**Historic Resources Group, LLC
Booth #21**



www.historicla.com
Peyton Hall, FAIA, Principal & Director of Architecture
323-469-2349
peyton@historicla.com
Historic preservation consulting.

**John Tiedemann Historic
Restoration, Inc.
Booth #11**

www.johntiedemann.com
Ray Tiedemann
201-207-7145
johntiedemann@comcast.net
Historic restoration and analysis of interior paint and plaster, as well as decorative painting and murals.

**Kopelov Cut Stone, Inc.
Booth #12**

www.kopelovcutstone.com
Labe Kopelov, Owner
505-867-0270
labe@kopelovcutstone.com
Natural cut stone fabrication with historically accurate finish.

**kubit USA
Booth #28**

www.kubitusa.com
Scott Diaz, Managing Director
281-506-2904
scott.diaz@kubitusa.com
From Real World to CAD: Software for capturing and documenting existing conditions.

**Lumenelle
Booth #02**

Peter Janko, President and Product Design Engineer
815-529-5483
pjanko@lumenelle.com
Historic lighting restoration and reproduction, energy retrofits.

**Master Paints & Chemical Corp.
Booth #34**

www.mastergroup-pr.com
Zoila Rivera, Sales & Logistics
787-314-9853
zrivera@mastergroup-pr.com
Lime putty, lime mortar and lime paint (lime restoration products).

**Michigan Ornamental Metals
Booth #25**

SPONSOR

www.westerngroup.com
Mike Radigan, Jr., Division Manager
201-945-4930
michaelra@michiganornamental.com
Specialty metal fabricator.

**Mollenhauer Group
Booth #06**

SPONSOR

www.mollenhauergroup.com
Gregory Hindson, President & CEO
213-624-2661
ghindson@mollenhauergroup.com
Construction, surveying, engineering.

**Morley Builders
Booth #30**

SPONSOR

www.morleybuilders.com
Tom Neary, VP-Director of Business Development
310-399-1600 x 201
tneary@morleybuilders.com
Expert preservation and modernization services based on a thorough methodology for handling historic preservation and modernization projects.

**National Center for Preservation
Technology and Training (NCPTT)
Booth #29**

SPONSOR

www.ncptt.nps.gov
Kirk Cordell, Executive Director
318-356-7444
Kirk_Cordell@nps.gov
NCPTT advances the use of science and technology in historic preservation. Working in the fields of archeology, architecture, landscape architecture and materials conservation, the Center accomplishes its mission through training, education, research, technology transfer and partnerships.

**Old World Stone Ltd.
Booth #35**

www.oldworldstone.com
Laurie Wells, V.P. Sales & Marketing
905-332-5547, ext. 26
laurie@oldworldstone.com
Custom fabricator of dimensional cut limestone and sandstone.

**Plan B Engineering
Booth #15**

SPONSOR

www.planbengineering.com
Ron Ehrenfeld, Principal
215-620-6534
re@planbengineering.com
Full service engineering company specializing in the design and implementation of systems that complement the construction industry.

**Preservation Trades Network, Inc.
(PTN)**

Booth #39

www.PTN.org
Rudy R. Christian, Executive Director
866-853-9335
rchristian@ptn.org
Provides education, networking and outreach for the traditional building trades.

Restore Media, LLC
Booth #17

SPONSOR

www.restoremedia.com
202-339-0744
Judy Hayward, Education Director
jhayward@restoremedia.com
Peter H. Miller, President
pmiller@restoremedia.com
Magazine publisher and conference
producer for the historic restoration and
rehabilitation market.

Robinson Iron
Booth #03

www.robinsoniron.com
J. Scott Howell, Vice President/General
Manager
256-329-8486
scotty@robinsoniron.com
Architectural Metals Restoration.

Shaws of Darwen Limited
Booth #05

SPONSOR

www.shawsofdarwen.com
Donald Swanson, US Representative
609-799-8214
swansonintl@comcast.net
Supplier of architectural terra cotta
for 112 years to the construction and
restoration market.

SightLine, LLC
Booth #01

www.sightlinescan.com
Penny Anstey, President
414-416-5024
penny@sightlinescan.com
3-dimensional laser scanning and as-
built documentation services.

Sponge-Jet, Inc.
Booth #04

SPONSOR

www.sponge-jet.com
Ted Valoria, Vice President of North
America
603-610-7950
tvaloria@spongejet.com
Environmentally friendly surface
cleaning, preparation and restoration
systems. See our live demonstration at
1:30 pm, Wednesday. See page 16 for
details.

WeRestoreBuildings.com
Booth #27

SPONSOR

www.werestorebuildings.com
Ray Adamyk, Founder and President
909-225-7880
radamyk@spectracompany.com
General contractor—historic
restoration, preservation and
conservation.

Western Construction Group
Booth #37

www.westernwaterproofing.com
Jennifer Kovach, Internal Quality
Control
415-225-4996
JenniferRK@WesternGroup.com
Building restoration and preservation.

Wooden Window
Booth #36

www.woodenwindow.com
Jeff Bent, Commercial Sales Manager
jeff@woodenwindow.com
510-893-1157 x201
Bill Essert, President
510-893-1157
bill@woodenwindow.com
Fabricate, rehabilitate and install
historic wooden doors and windows.

APT CHAPTERS

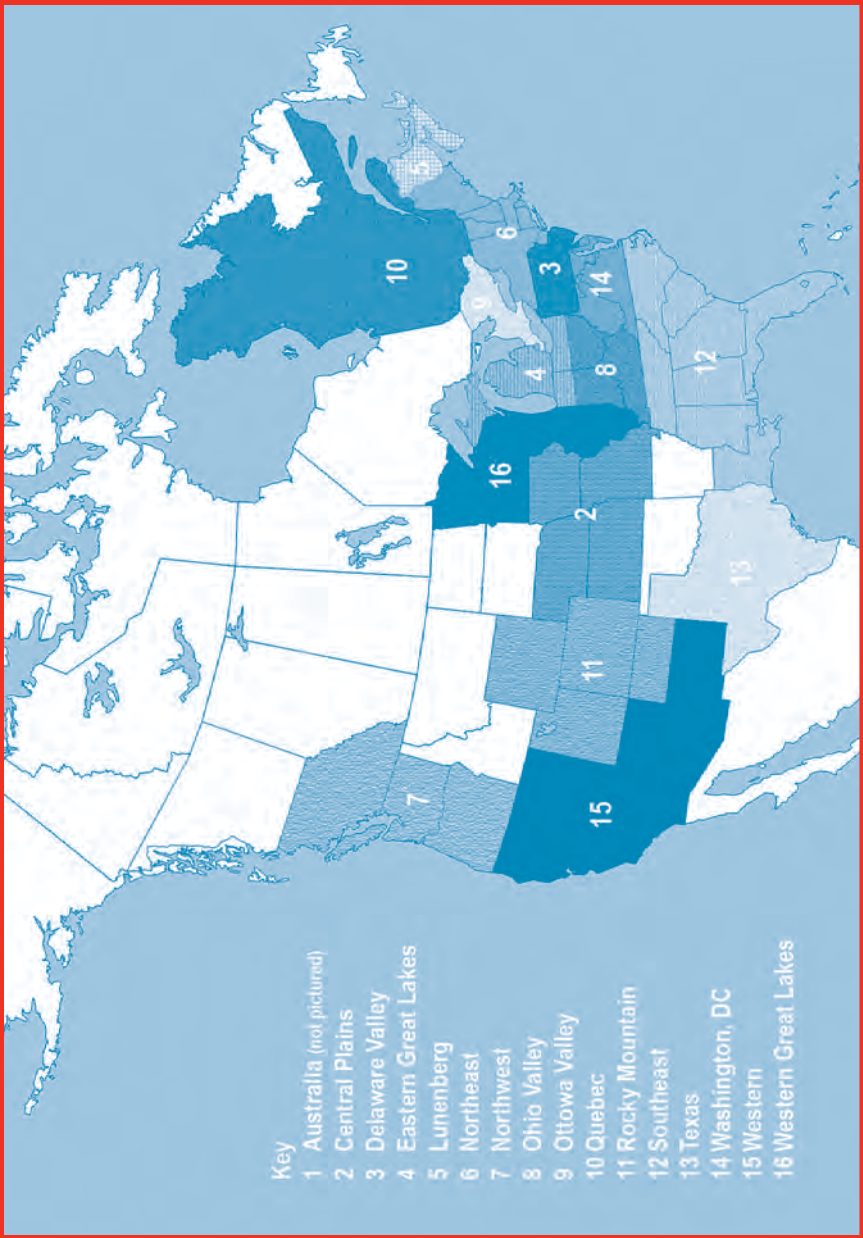

FOR INFORMATION ABOUT JOINING AN **APT CHAPTER**
VISIT US AT **BOOTH #41.**



**Layers across Time:
Preserving a Diverse Western Heritage**

**APT Denver 2010
October 6-9
Sheraton Denver Hotel**

APT is accepting abstracts for its APT Denver 2010 Conference
The deadline for submissions is February 22, 2010
The Call for Papers is in your Conference Tote Bag
and on line at www.apti.org
The electronic Abstract Submission Form is
on line at www.apti.org

Association for Preservation Technology International
3085 Stevenson Drive, Suite 200 • Springfield, IL 62703 USA
Tel: 217.529.9039 • Fax: 888.723.4242 • info@apti.org
www.apti.org

