



2019 CONFERENCE PROGRAM

PREMIER SPONSOR



The logo for KEIM, featuring the word "KEIM" in a bold, white, sans-serif font with a red triangle pointing downwards from the letter "I".

COLORS FOREVER.

A large, ornate church building with a prominent dome and a large rose window. The building is light-colored with gold accents. The sky is blue with scattered white clouds.

YOUR PARTNER IN MASONRY RESTORATION

KEIM invented mineral silicate paints in 1878 and has been innovating with a proven track record ever since. No one has more experience or know-how, and no one has more field technicians and sales personnel.

A smaller, close-up view of the church's dome and upper facade, showing intricate architectural details and the green-tinted glass of the dome.

Just ask us and we'll guarantee a flawless project from beginning to end.

Memorial Presbyterian Church, St. Augustine, FL completed 2019

www.keim-usa.com

WELCOME TO MIAMI!

APT Board of Directors Executive Committee

Kitty Vieth
President

Dean Koga
Past President

Gina Crevello
Vice President
Co-Chair Development Committee

Natalie Feinberg-Lopez
Vice President
Co-Chair Training and Education Committee

James Shepherd
Treasurer

Paul Kuenstner
Executive Director

Directors

James Banta
Co-Chair Membership Committee

Lena Buchinger
Director-at-Large, Co-Chair Chapters Committee

Stefan Cieslik
Co-Chair Training and Education Committee

Kristen Craig
Co-Chair Membership Committee

Art Femenella
Director-at-Large, Co-Chair Development Committee

Erin Fisher
Director-at-Large, Co-Chair Training and Education Committee

Caterina Giovannini
Co-Chair Partnerships and Outreach Committee

Jill Gotthelf
Co-Chair Conferences Committee

Lyles McBratney
Co-Chair Conferences Committee

Annabelle Radcliffe-Trenner
Co-Chair Partnerships and Outreach Committee

Cristina Radu
Director-at-Large, Co-Chair Publications Committee

Claudia Rodriguez
Director-at-Large, Co-Chair Chapters Committee

Elaine Shapiro
Director-at-Large, Co-Chair Student Scholarships and Outreach Committee

Justin Spivey
Co-Chair Publications Committee

Christina Wallace
Co-Chair Student Scholarships and Outreach Committee

Greta Wilhelm
Director-at-Large, Co-Chair Chapters Committee

Taryn Williams
Co-Chair Partnerships and Outreach Committee

On behalf of the Association for Preservation Technology International, I am pleased to welcome you to APT's first conference in Florida. The city of Miami is diverse culturally as well as architecturally, setting the stage for an exciting conference. Miami's subtropical location on the Atlantic Ocean highlights critical issues of climate change, which will be explored in the opening symposium and paper sessions.

Miami is the first conference location for a new APT initiative on community engagement and diversity. Over the past year, a dedicated group of APT members from multiple committees have been working with local students and community members on preservation issues in the Little Haiti neighborhood. At the conference, there will be a field session in Little Haiti, which will be followed by a presentation of the Little Haiti Community Engagement Project at the Little Haiti Cultural Center.

Thank you to Rosa Lowinger and Kyle Normandin, conference co-chairs, the local conference committee and the conference sponsors who made this all possible.

I look forward to sharing a fantastic conference with you!

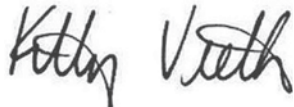

Kitty Vieth, AIA, LEED AP
APT President

¡Bienvenidos!

This year's APT Conference tackles the most urgent preservation challenges facing the 21st century; some of these include climate change, tourism, development pressures, and gentrification, and how these forces are shaping heritage places and urban cities around the globe.

Miami is a uniquely diverse city where these issues converge and impact the way people live today. As the conference co-chairs, we are advancing a program of diversity and inclusion that features voices of professionals from across the hemisphere and abroad to engage the current dialogue on future conservation practice and preservation strategies.

We hope you will find our program thought provoking and encouraging, and that you make time to enjoy the sounds and flavors of Miami, the Magic City.



Rosa Lowinger and Kyle Normandin
Conference Co-Chairs

Committee:

Jill H. Gotthelf, *APT Conferences Committee*

Lyles McBratney, *APT Conferences Committee*

Nancy Rankin and Cory Rouillard, *Symposium*

Lurita McIntosh Blank, *Programming Committee*

Paul Gaudette and Kelly Ciociola, *Workshops Committee*

Nina Caruso, *Field Sessions Committee*

For a full list of all the individuals and committees see the mobile app.



Biofilm Removal From Thomas Jefferson Memorial, Washington, D.C.
1st 1,000 Square Feet Of Marble Dome Laser Cleaned with the GC-1.

Unmatched Laser Cleaning Precision!

GC 
LASER SYSTEMS
LaserCleanIt.com
(844)-532-1064



Patented Circular Scan
Removing Rust

Patented laser cleaning technology that is designed by conservators specifically for fine art and architecture conservation that offers unmatched precision and control over the level of cleaning of many materials. Made in the USA. Sold worldwide.

Sales + Rentals + Certification + Training + Technical Support



SBA WOSB
Woman Owned Small Business

Historic Architectural Terra Cotta
Left Half Laser Cleaned

TABLE OF CONTENTS

Conference Sponsors	4
Agenda-At-A-Glance	6-7
Hotel Map	8
Symposium	9
Workshops	9
Field Sessions	10
Special Events & Networking	11-12
Committee Meetings	12
Plenary Sessions	13
Paper Sessions:	
CS1	14
CS2	16
CS3	18
CS4	20
CS5	22
Scholarship Recipients	24
Student Engineering Competition	25
Getty Travel Recipients	26
Exhibitors	27-30
Demo Pavilion	30
City Area Map	31
General Information and Mobile App	32

CONTINUING EDUCATION

APT is an approved provider for the following professional continuing education credits: AIA, ASLA and RCEP. Continuing Education Certificates can be obtained via the mobile app after completing evaluations for each session attended. Hours will be reported to AIA, RCEP or ASLA based on your certificate activity within 60 days of the conference.

- American Institute of Architects Learning Units (AIA LUs)
- Canadian Architects: all provinces will accept AIA-approved CEs to fulfill requirements.
- RCEP Professional Development Hours (RCEP PDHs)
- American Society of Landscape Architects (ASLA LUs)



2019 SPONSORS

PREMIER



PLATINUM



GOLD



SILVER



SILVER



BRONZE

American Institute of Architects
 Boston Valley Terra Cotta
 Echem Consultants LLC
 IBIX North America

Integrated Conservation Resources/
 Integrated Conservation Contracting
 John Canning & Co., Ltd.
 Kuenstner LLC
 Stained Glass Association of America

SCHOLARSHIP DONORS

Annabelle Radcliffe-Trenner
 APT NE Chapter
 APT NW Chapter
 Arthur Femenella
 Business Endeavors
 Catarina Giovannini
 Christina Wallace
 David Wessel
 Dean Koga
 Elaine Shapiro
 Felicia McBratney
 Gina Crevello
 Hugh Miller
 Ilene Tyler

James Banta
 James Shepherd
 Jeffrey Mark Chusid
 Jill Gotthelf
 Joan Berkowitz
 Justin Spivey
 Kitty Vieth
 Kristen Craig
 Kyle Normandin
 Lena Buchinger
 Lesley Gilmore
 Lois Nelson
 Lonnie Hovey
 Margret Wilhelm

Mary Jablonski
 Michael Jackson
 Michael Patrick
 Michael Schuller
 Mount Ida Press
 Nancy McCoy
 Natalie Feinberg Lopez
 Paul Kuenstner
 Robert Mack
 Rocky Mountain Chapter of APT
 Ronald Anthony
 Stefan Cieslik
 Stephen Kelley
 Taryn Williams

AGENDA-AT-A-GLANCE*

* At time of printing. For the most up-to-date agenda, and conference details, download the mobile app . \$ - Additional fee to attend.

Tuesday, November 19

7:00am - 6:30pm	Registration	Junior Ballroom Foyer
7:30am - 8:15am	Symposium Continental Breakfast (for Symposium attendees)	Flagler
8:30am - 5:00pm	Symposium: Heritage Values and Climate Action Planning (\$)	Tuttle/Gusman

Wednesday, November 20

7:00am - 6:30pm	Registration	Junior Ballroom Foyer
7:15am - 8:00am	BOD Continental Breakfast	Bayfront B
7:15am - 8:00am	WS Continental Breakfast	Junior Ballroom Foyer
8:00am - 5:00pm	Board of Directors Meeting	Bayfront A
8:00am - 4:30pm	WS1: Post-Disaster Safety Evaluations for Existing Structures (\$)	Tuttle/Gusman
8:00am - 4:30pm	WS2: Conservation of Modern Concrete and Terrazzo Flooring (\$)	Flagler
8:00am - 4:30pm	WS3: Understanding the Role of Material Testing in the Preservation Design Process (\$)	Dupont
8:30am - 4:30pm	Various Field Sessions: Meet on 1st Floor (\$)	See page 10
6:30pm - 8:30pm	SE1: Evening Soiree Celebrating 500 Years of Havana History	The Jewel Box

Thursday, November 21

7:00am - 6:30pm	Registration	Mezzanine
8:00 am - 4:45pm	WS1, WS2, WS3	See Wed. Locations
8:30am - 4:30pm	Various Field Sessions: Meet on 2nd Floor (\$)	See page 10
10:00am - 2:00pm	Little Haiti Community Project and Lunch	See page 11
1:00pm - 4:00pm	COF: College of Fellows Business Meeting	Sandringham/Windsor
1:00pm - 4:45pm	PETC Student Workshop	Balmoral
2:00pm - 5:00pm	LAC: Latin American Chapter Meeting	Brickell
2:00pm - 4:00pm	Partnerships & Outreach Committee	Merrick 1
2:00pm - 4:00pm	TC Documentation	Merrick 2
4:00pm - 5:00pm	SSOC: Student Scholar Meet and Greet	Biscayne
5:00pm - 6:30pm	KS1: Welcome and Keynote Address	Chopin
6:30pm - 9:30pm	SE2: Exhibit Gala	Mezzanine
8:00pm -10:00pm	SSOC: Student Scholar Practice 1	Chopin
8:00pm - 10:00pm	SSOC: Student Scholar Practice 2	Biscayne

Friday, November 22

7:00am - 6:30pm	Registration	Mezzanine
7:00am - 8:15am	Continental Breakfast	Mezzanine
7:00am - 8:30am	Publications Committee	Merrick 1
7:00am - 8:30am	TC Modern Heritage	Merrick 2
7:00am - 8:30am	OSCAR	Sandringham/Windsor
7:00am - 5:00pm	Exhibit Hall	Mezzanine
7:00am - 5:00pm	SE10: Engineering Competition and Getty Posters Display	Grand Ballroom Foyer

Friday, November 22

8:15am - 10:30am	PETC Engineering Competition Timed Arch Build and Arch Loading	Ballroom Foyer
8:30am - 10:00am	Concurrent Plenary Sessions	See page 13
10:30am - 12:00pm	CS1: Concurrent Paper Sessions	See page 14
12:15pm - 1:15pm	Lunch at Exhibit Hall	Mezzanine
12:15pm - 1:30pm	ZNCC: Collaborating Toward Net Zero	Merrick 1
12:15pm - 1:30pm	TC Materials	Sandringham/Windsor
12:15pm - 1:30pm	SE5: Student Recognition Lunch (\$)	Trianon
1:30pm - 2:45pm	APT Annual General Meeting (AGM) and 2020 Preview	Trianon
3:00pm - 4:30pm	CS2: Concurrent Paper Sessions	See page 16
4:30pm - 6:00pm	TC Codes	Alhambra
4:30pm - 6:00pm	Training and Education Committee	Merrick 1
4:30pm - 6:00pm	TC Preservation Engineering	Merrick 2
4:30pm - 6:00pm	Student Scholar Outreach Committee	Sandringham/Windsor
4:30pm - 6:00pm	TC Sustainable Preservation	Bayfront A
4:30pm - 6:00pm	Membership Committee Meeting	Trianon
5:30pm - 6:30pm	SE6: Emerging Professionals Mixer (\$)	Michaelangelo/Raphael
6:00pm - 6:45pm	SE7: AIA-HRC Reception	Grand Ballroom Foyer
7:00pm - 7:30pm	SE8: HABS/Peterson Awards Presentation	Versailles
7:30pm - 9:00pm	KS2: College of Fellows Keynote and Installation	Versailles
9:00pm - 11:00pm	SE3: Chapters Mixer	The Wolfsonian

Saturday, November 23

7:00am - 6:30pm	Registration	Mezzanine
7:00am - 8:30am	SE9: Chapters Breakfast (\$)	Trianon
7:30am - 8:15am	Continental Breakfast	Mezzanine
7:30am - 3:00pm	Demo Pavilion	Mezzanine
8:00am - 5:00pm	PETC Student Workshop	Balmoral
8:30am - 10:00am	PL5: College of Fellows Roundtable Discussion	Versailles
8:30am - 10:00am	PL6: Latin American Chapter / Getty Roundtable Discussion	Chopin
10:30am - 12:00pm	CS3: Concurrent Paper Sessions	See page 18
12:15pm - 1:15pm	Lunch at Demo Pavilion	Mezzanine
12:00pm - 1:15pm	Board of Directors Meeting	Sandringham
12:15pm - 1:15pm	APT Authors Forum	Escorial
1:30pm - 3:00pm	CS4: Concurrent Paper Sessions	See page 20
3:30pm - 5:15pm	CS5: Concurrent Paper Sessions	See page 22
5:30pm	PETC Engineering Competition Winners Announced	Balmoral
6:00pm - 11:30pm	SE11: APT Awards Banquet (\$)	Bayfront Ballroom

HOTEL MAPS

First Floor

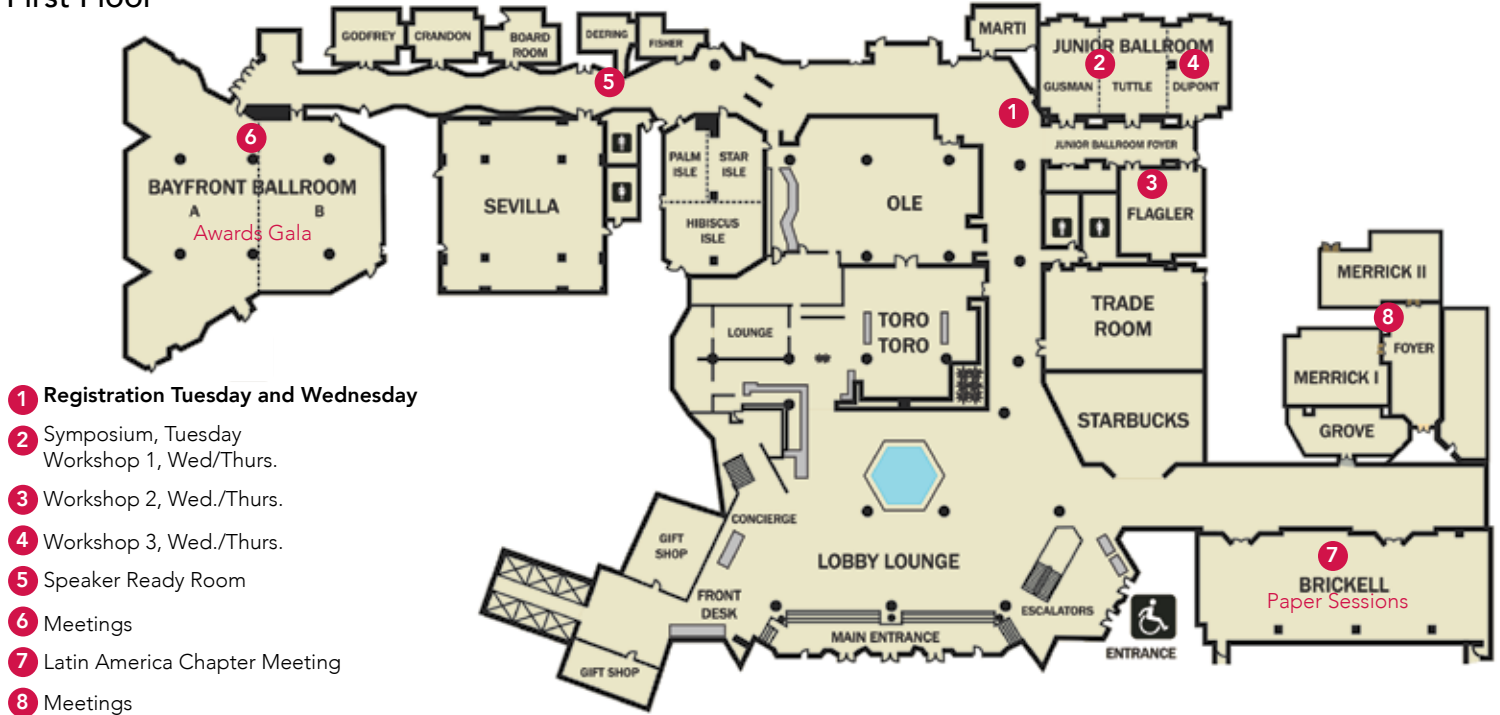

Second Floor



SYMPOSIUM & WORKSHOPS

Tuesday, November 19

2019 Symposium (\$) Additional fee to attend.

Heritage Values and Climate Action Planning
8:30am - 5:00pm, Tuttle/Gusman, 1st Floor

Sponsored by:



A day-long opening symposium will focus on the reciprocal intersections between historic preservation and climate change. How do we capitalize on our expertise in preservation technology to effectively motivate climate action across the world and at multiple scales? Using the 2015 Paris Climate Agreement as a framework, the symposium will identify and highlight the necessary and expanding role of historic preservation in developing climate solutions around climate adaptation, greenhouse gas (GHG) mitigation and planning for loss and damage; stimulating awareness of climate policies and actions; and supporting critical research. Policy and practice examples from south Florida, the Gulf Coast, the Caribbean Islands, Latin America, Great Britain, Italy, the Netherlands, and southern Asia will be featured.

Wednesday, November 20 and Thursday, November 21

2-Day Workshops (\$) Additional fee to attend.

Workshops will take place on the first floor, registration is past the Starbucks®
Wednesday, November 20 8:00am - 4:30pm
Thursday, November 21 8:00am - 4:00pm

WS1: Post-Disaster Safety Evaluations for Existing Structures (ATC-20 SAP and ATC-45)

The workshop will discuss the importance of preservation-minded professionals and contractors in the protection of heritage buildings. In addition to the ATC courses, case studies and strategies will be presented by APT that demonstrate how these assessments can be implemented responsibly with an eye toward minimizing unnecessary restrictions and destruction of these heritage structures.

Learning Objectives:

- Educate attendees in the ATC-20 and ATC-45 methods (and manuals) for the performance of rapid building evaluations following high-speed wind, flood and earthquake events.
- Educate attendees on the ATC methods of post-disaster assessment building classification and methods for notification (e.g., posting of classification placards and reporting). Participants will learn how placards are utilized to identify if the building has been inspected, has restricted use and/or is unsafe.
- Specialized training will be provided on the evaluation procedures for essential facilities (e.g., hospitals), non-structural elements, geotechnical hazards and human-behavior following earthquakes.
- Present attendees focused discussion on the assessment of both heritage structures and heritage artifacts following disasters. Covered topics include advanced assessment strategies and available technologies with unique conditions encountered during post-disaster recovery challenges.

WS2: Conservation of Modern Concrete and Terrazzo Flooring

The two-day workshop will primarily cover preservation philosophy and approach for modern concrete and cement-based terrazzo flooring systems. Specific topics will include assessment and nondestructive testing, laboratory studies, concrete cleaning, repairs (including matching modern historic concrete), corrosion mitigation, and protection.

Learning Objectives:

- Understand the history, manufacture and installation techniques of historic and modern concrete and terrazzo flooring.
- Understand what factors contribute to deterioration of concrete and terrazzo, and how deterioration of these materials can be investigated, evaluated, and analyzed.
- Learn how to develop appropriate repair and conservation strategies and goals for historic and modern concrete and terrazzo.
- Learn various approaches for repair and conservation treatments, how to tailor to specific projects and how they are implemented

WS3: Understanding the Role of Material Testing in the Preservation Design Process

The two-day workshop will thoughtfully approach using materials analysis to inform preservation design. Specific topics will address: materials testing philosophy and methods; necessary research and survey before testing; sampling considerations; strategies for efficient data collection; the testing process and standardization in testing; interpretation of test results; communicating with the project team; data interpretation and using the results; and cost, budget, and schedule.

Learning Objectives:

- Understand the process of developing a thoughtful testing program including collaborative input from the Project Team: Owner, Architect, Conservator, Scientist, and Contractor.
- Explain what factors contribute to the selection of specific types of testing based on the observed conditions, client needs, project objectives, schedule, and available budget.
- Understand how to develop appropriate questions that materials testing can answer as they relate to the project, building and materials.
- Remember various approaches for testing, sampling, scientific processing and interpreting obtained data and communicating results and recommendations to the Project Team in lucid and useful reporting to move a project forward.

FIELD SESSIONS (FS) (\$)

Additional fee to attend, inquire at APT registration for availability.

Wednesday Field Sessions

Times posted are time of departure from the first floor. Check in at APT Registration. Please arrive 30 minutes prior.

Full Day Field Session

FS09: Coral Gables

Departs 8:15am

Join guides from the Historic Preservation Association of Coral Gables to tour historic home of City founder George Merrick, Coral Gables Congregational Church, Venetian Pool, Coral Cables City Hall, and the Miami-Biltmore Hotel and Country Club.

Morning Half-Day Field Sessions

FS01: Vizcaya Museum & Gardens

Departs 8:30am SOLD OUT

Vizcaya is one of the United States' most intact architectural examples from the Gilded Age.

FS02: Downtown Miami Historic Architecture Walking Tour

Departs 8:30am SOLD OUT

See Miami's collection of Commercial, Masonry Vernacular, Mediterranean Revival, Art Deco, Art Moderne, Neoclassical Revival and Italian Renaissance Revival buildings built between 1913-1955.

FS03: Private Stiltville & Key Biscayne Cruise with Dr. George

Departs 8:30am SOLD OUT

HistoryMiami Museum's Resident Historian Dr. Paul George will share the history of Biscayne Bay, and Miami Marine Stadium architect Hilario Candela, will talk about his award-winning modern masterpiece and current conservation plan.

Afternoon Half-Day Field Sessions

FS04: U of Miami Campus - School of Architecture

Departs 12:30pm

This half-day tour of the main Coral Gables campus will be led by faculty from the School of Architecture. The tour will include a visit to the Lowe Art Museum, one of Miami's first art museums.

FS05: Private Miami River Cruise with Dr. George

Departs 12:30pm SOLD OUT

HistoryMiami Museum's Resident Historian, Dr. Paul George will share the story of the Miami River from the late 19th century.

FS06: FIU Design Studio + Lincoln Road MDPL Walking Tour

Departs 12:30pm

Walk Lincoln Road, a 1960s pedestrian mall by noted Miami architect Morris Lapidus, and a visit to Florida International University's Miami Beach Urban Studios. Led by architect and MBUS director John Stuart, attendees will get a chance to experience MBUS 3D printing laboratories- one of the largest in the United States.

FS07: Miami Modernism (MIMO) Bus Tour

Departs 12:30pm

Learn about this special architecture and the elements that make MIMO. Tour the Miami Beach MIMO District plus the Miami MIMO Biscayne Corridor to see this special architecture. Projects include Miami Beach's famed Fontainebleau and Eden Roc Hotels, plus newer restorations including the Hotel on Biscayne.

FS08: Wynwood Walls Graffiti Tour

Departs 2:30pm SOLD OUT

See the transformation of the once rundown district of Wynwood into the internationally renowned "Wynwood open-air museum".

Thursday Field Sessions

Times posted are time of departure from the second floor. Please arrive 30 minutes prior.

Morning Half Day Field Sessions

FS10: Private Little Havana & Overtown Walking Tour

Departs 8:30am SOLD OUT

Walk down the vibrant Calle Ocho. Discover the significance of the Ceiba Tree, Cuban music and dance, learn the art of cigar making.

FS11: Buena Vista & MIA Design District

Departs 8:30am SOLD OUT

Walk the historic tropical HPOZ, and continue with a tour led by the district's curator Tiffany Chestler. See how the developers used cutting edge materials to showcase fashion and artworks.

Afternoon Half-Day Field Sessions

FS17: Glam Hotels

Departs 12:30pm SOLD OUT

Learn about the Miami Beach glam hotels of the 30s, 40s and 50s and experience the vibrant energy that fills the streets of South Beach.

FS12: Art Deco & The Wolfsonian

Departs 12:30pm SOLD OUT

Visit the 1927 Washington Storage Company, a Mediterranean Revival building that currently houses the Wolfsonian Museum of Decorative and Propaganda Arts. Walk along Ocean Drive, Collins and Washington Avenues.

FS13: Private Island of Biscayne Bay Cruise with Dr. George

Departs 1:00pm SOLD OUT

HistoryMiami Museum's Resident Historian, Dr. Paul George will share the rich history of Fisher Island, once owned by Miami's first African American millionaire, D.A. Doresey. See Flagler Memorial Island, and Plam Island.

Full Day Field Sessions

FS14: Missiles and Modernism in the Everglades

Departs 8:30am

The tour will visit the National Register-listed HM-69 Nike Missile Site, and then travel to the Flamingo Developed Area to view the National Park Service Modernist planning and architecture. National Park Service cultural personnel will participate in the tour and discuss challenges and current planning to address threats to natural resources and the cultural landscape.

FS16: Miami's Contemporary Architecture Bus Tour

Departs 8:30am

The Miami skyline features contemporary architectural designs by the notable architects; world class masters like Herzog & deMeuron, Zaha Hadid, Norman Foster, Rem Koolhaas, Architectonica, Frank Gehry, BIG-Bjarke Ingels Group, Renzo Piano and renowned "starchitects". Tour the buildings along Biscayne Boulevard, Brickell Avenue and in Miami Beach that incorporate the latest in technology, art, sustainability and engineering.

SPECIAL EVENTS (SE) & NETWORKING

Wednesday, November 20

SE1: Evening Soiree Celebrating 500 Years of Havana History at the Jewel Box

6:00pm - 9:00pm **FULL**

Attendees must have pre-registered for this event, no additional capacity is available. Transportation to the venue is on your own.

Thursday, November 21

KS1: Welcome and Opening Keynote

5:00pm - 6:30pm, Chopin

Keynote: Gustavo Araoz, ICOMOS



Gustavo Araoz will reflect on what can be done and what is being done to meet the challenges posed by the double moving target of preserving heritage as understood today, whose nature and values are constantly evolving and doing so under the difficult circumstances resulting from the four themes being explored in this year's conference. While the effects of climate change in warm weather

coastal regions threatens heritage places, they also threaten the very existence of the human settlements. The topic of sustainable conservation has been permanent concern in all heritage conservation theories, having been embedded in the Venice Charter of 1964 and even before. The conservation of modern and post-modern heritage is new phenomenon that allows living generations to decide which of its accomplishment will be entrusted for the future to preserve as the heritage of tomorrow. Fourthly, the challenges presented by diversity, population change, and gentrification in the preservation dialogue, while also an old issue, will grow increasingly more contentious as previously invisible stakeholder communities acquire ever greater power to identify, define and manage their communal heritage.

SE2: Exhibit Gala and Welcome Reception

6:30pm - 9:30pm, Mezzanine

Join us right after the opening keynote in the Mezzanine for our Exhibit Gala. Network with fellow attendees and find out about the services and products our exhibitors will be showcasing while enjoying appetizers and libations. Grab a bite and some great info tonight! Free to all registered attendees. Cash bar.

SE3: Chapter's Mixer at the Wolfsonian

9:00pm - 11:00pm **FULL**

Attendees must have per-registered for this event, no additional capacity is available. Transportation to the venue is on your own.

Friday, November 22

SE5: APT Student Recognition Lunch

12:15pm - 1:30 pm, Trianon

(\$) Additional fee to attend.

Join us as we recognize the 2019 Student Scholars, their mentors and school advisors as well as the 2019 Student Design Build Competition Teams. Tickets, if available, may be purchased at the APT Registration desk during normal hours. The APT Annual Meeting will immediately follow the luncheon.

APT Annual General Meeting

1:30pm - 2:45pm, Trianon

In addition to APT updates, meet the 2019 APT recognized professionals and get a sneak peek at the 2020 joint conference with National Trust for Canada! Open to all attendees.

SE6: Emerging Professionals Mixer

7:00pm - 7:30pm, Michaelangelo/Raphael

(\$) Additional fee to attend. **SOLD OUT**

The Technical Committee on Modern Heritage invites you to come meet APT members and learn how to become more involved in the committee!

CP1: Tour of Little Haiti

9:45am - 12:00pm **FULL**

Please join APT in our celebration with the CLEO Institute, the University of Miami, the City of Miami, La Perle de Miami, and the residents of Ti Ayiti (Little Haiti) to highlight the collaborative efforts to keep the historic Little Haiti neighborhood intact. The goal of this initiative was to highlight the cross roads of preservation, sustainability and resiliency, and empower local community members through workshops and educational engagements. APT members led teams of students and community members in the assessment of historic residential properties to identify significant historic features and inherent sustainable design elements, identification of vulnerabilities and threats, and development of cost effective upgrades for enhanced performance and increased resilience. Building upon this effort, these residences are eligible for grants from the City of Miami for resilience upgrades. Little Haiti is the pilot project for APT's Community Engagement initiative, designed to deepen the relationship between APT and the local community where we hold our annual conference.

CP2: Little Haiti Cultural Center Lunch and Celebration

12:00pm - 2:00pm **LIMITED SEATING**

Initiative leaders will review the project from the Little Haiti Cultural Center's Market Place, with local vendors available. Local dance and music will accompany the presentations of UM students, and project finding. Free to attend, but registration is required. Meet at the Starlight Terrace (2nd floor) at 11:30am for transport.

SE7: AIA-HRC Reception

6:00pm - 6:45pm, Grand Ballroom Foyer

Historic Resources
Committee
an AIA Knowledge Community



The AIA Historic Resources Committee invites you to join them for a cocktail before the HABS/Peterson Awards and the College of Fellows Installation and Keynote. Open to all attendees, cash bar available.

SE8: HABS/Peterson Awards Presentation

7:00pm - 7:30pm, Versailles

The winning team of the Peterson Prize Measured Drawings Student Competition will be presented as well as a slide show of the winner's drawings. The prize honors Charles E. Peterson, FAIA, founder of the Historic American Buildings Survey (HABS), and is intended to increase awareness, knowledge, and appreciation of historic buildings, structures, and cultural landscapes throughout the United States.

SPECIAL EVENTS (SE) & NETWORKING

Friday, November 22

KS2: College of Fellows Keynote and Installation

7:30pm - 9:00pm, Versailles

Keynote: Tracy Metz

Sponsored by



Sweet and Salt, cultural and engineering lessons from the Dutch in a time of global climate change.

What is so special about the Dutch approach to water management? Why does the call 'Bring in the Dutch!' ring out in so many countries across the world when they are hit by floods? This talk will address the distinguishing cultural and

engineering aspects of Dutch water management. One of those aspects is sheer experience: the Netherlands has out of necessity become masters of the waters, given that a third of the country is below sea level. Throughout its history, the country has developed a highly sophisticated system of defense from the sea and the rivers that flow it from the European hinterland to the North Sea. This man-made landscape does, however, require continual tuning and maintenance. And as the climate changes, the Dutch are discovering that centuries of intervention in the landscape and the underlying natural systems are not without consequences. They are therefore now looking to formulate a new relationship to water called 'building with nature': less defensive, more accommodating, allowing controlled flooding and creating more space for water in the cities.

area, as well as members from other chapters. Space permitting, tickets may be purchased at registration.

APT Author's Forum

12:15pm - 1:15pm, Escorial/Alhambra

APT will be hosting its first forum for APT members who are authors to present their recently published books. The books to be presented are from authors and members attending the conference who have written and published their work within the last two years. Please join us for this exciting opportunity to meet with the authors and learn more about their research and writing. Bring your lunch and join in on the conversation.

SE11: APT Annual Awards Banquet

6:00pm - 11:30 pm, Bayfront Ballroom, 1st floor

(\$ Additional fee to attend.

6:00pm Cocktails

6:30pm Salsa dance lessons

7:00pm Dinner Program

8:30pm Live Auction

A banquet, a view and a chance to bid on something too! Join us to recognize the work and accomplishments of our APT members. Afterwards, we will have an auction to support the student scholar program, but instead of dessert, it will be destinations! Here is a sampling of what you can bid on:

- 1 Week guest house stay in Miami Florida
 - 1 Week guest house stay in Los Angeles, CA
 - 2 nights in a Historic Hotel in Miami
 - 2 nights at the historic Chattaqua Hotel, Boulder, CO
 - 1 Week villa stay in Latina Italy
 - 1 Week stay at the Captiva Island House, Captiva Island, Florida
 - A Velvet Rope Gamble House Tour, Pasadena, CA
 - 2020 APT Edmonton Conference Package, 4 nights+registration
- Dress up, raise a glass, and celebrate with us! Cocktail attire optional.

Saturday, November 23

SE9: Chapters Breakfast Meeting,

7:00am - 8:30am, Trianon

(\$ Additional fee to attend.

Rise and shine, grab a great breakfast and connect with professionals from the APT Chapter that represents your geographical

COMMITTEE MEETINGS

All APT members can join and participate in committee meetings. It is a great way to share your talents and get involved!

Thursday, November 21

2:00pm - 4:00pm

Partnerships & Outreach

Merrick 1

2:00pm - 4:00pm

TC-Documentation

Merrick 2

Friday, November 22

7:00am - 8:30am

Publications

Merrick 1

7:00am - 8:30am

TC-Modern Heritage

Merrick 2

7:00am - 8:30am

OSCAR

Sandringham

12:15pm - 1:30pm

ZNCC: Collaborating Toward Net Zero

Merrick 1

12:15pm - 1:30pm

TC-Materials

Sandringham/Windsor

4:30pm - 6:00pm

Training & Education Committee

Merrick 1

4:30pm - 6:00pm

TC-Preservation Engineering

Merrick 2

4:30pm - 6:00pm

Membership

Trianon

4:30pm - 6:00pm

TC-Codes

Alhambra

4:30pm - 6:00pm

Student Scholar Outreach Committee

Sandringham/Windsor

4:30pm - 6:00pm

TC-Sustainable Preservation

Bayfront A

Friday, November 22

PL1: Plenary (Track 1) Effects of Climate Change in Warm Weather Coastal Regions

8:30am - 10:00am Brickell, 1st Floor

This plenary session will describe how climate change is projected to affect coastal areas, the data being used to make these predictions, methods for assessing the vulnerability of cultural heritage, and ways that communities are adapting to expected changes. The session will include a few iconic cities as examples, including Miami, Rome, Florence, and the broader Caribbean region. Speakers will discuss what these communities are doing to create plans for adapting to projected climate change and how they are incorporating the value of cultural heritage into such plans.

Session Chair: Rita Teutonico

Presenters:

Todd Cowl

Fernando Nardi

Fabio Castelli

Susanne Torriente

PL2: Plenary (Track 2) Sustainability and Conservation of Built Heritage in the Americas

8:30am - 10:00am Chopin, 2nd Floor

Come Rain or Shine—A conversation on the effects of climate change and tourism on the ongoing stewardship of La Habana, Cuba; Trinidad, Cuba; and Cartagena de Indias, Colombia. The topics of this panel discussion will range from the presentation of speculative remedial projects to a discussion of data banks and resources for climate effects on the subject cities and an ongoing discussion on conversation and management techniques as part of stewardship responsibilities.

Session Chair: Jorge Hernandez

Presenters:

Nancy Benitez

Universo Garcia

José Martin-Caro

Edith Salas

PL3: Plenary (Track 3) New Frontiers for the Preservation: Conserving the Modern City

8:30am - 10:00am Versailles, 2nd Floor

The plenary session builds on a dialogue captured during the international conference held in Casablanca in 2018 titled "Conserver la ville moderne [Preserving the Modern City]". Representatives emphasized how modern architecture was implemented within the historic context rather than against it. This session proposes to extend the discussion to the modern urban context inherent in Latin American cities and specifically those where modern architecture has strongly contributed to their contemporary urban landscape.

Session Chair: Jean-Francois LeJeune

Presenters:

Carlos Eduardo Comas

Farés el-Dahdah

Pablo Guiraldes

Danae Peguero Bueno

PL4: Plenary (Track 4) Giving Voice and Agency to Others in a New Era of Preservation Practice

8:30am - 10:00am Biscayne, 2nd Floor

The plenary will explore issues regarding the representation and participatory role of diverse publics in shaping conservation decision-making. This session will examine how more inclusive approaches to preservation can move beyond information gathering and toward shared decision-making with diverse and multigenerational publics. It will also consider how questions of equity and social impact can inform preservation strategies, from technical research to regulatory policy. Cases will illustrate the evolving nature of inclusive practice in differing geo-cultural contexts, including urban and rural, and at varying political scales, local to national. Through these examples and robust exchange among the speakers, this session will explore the challenges and opportunities ahead for re-imagining the role and uses of heritage in the social and physical fabric of communities.

Session Chair: Erica Avrami

Presenters:

Brent Leggs

Theresa Pasqual

Claudia Guerra

Saturday, November 23

PL5: COF Roundtable and Discussion - Post-Disaster Mitigation Strategies for Cultural Heritage Sites

8:30am - 10:00am Versailles, 2nd Floor

This roundtable will explore how different sites and communities in the Caribbean and Americas have had to confront these critical issues. The panel will focus on the challenge of preserving indigenous architecture, landscapes and communities in the face of mounting natural and human threat. Instances where repair and reconstruction have led to greater visibility for previously ignored cultures and communities will be discussed. As a follow-up to the 2018 COF roundtable in Buffalo, the panel will delve into the complexities of recovery, rehabilitation, and reconstruction of damaged or destroyed sites, and how the questions and challenges that arise go well beyond authenticity and integrity.

Session Chair: Gustavo F. Aroz

Presenters:

Melyvn Green

Lauren Hall

Michael Schuller

Additional information on the plenary sessions and speakers can be found on the mobile app.

PAPER SESSIONS

<p>Track 1 Effects of Climate Change in Warm Weather Coastal Regions</p> <p>CS1.1 Projections of Climate Change</p>	<p>Track 2 Sustainability and Conservation of Built Heritage in the Americas</p> <p>CS2.1 Building Resiliency in Pre-colonial, Maritime and Post-colonial Heritage Sites Affected by Climate Change, Part1</p>
<p>BRICKELL, 1st Floor 10:30am - 12:00pm</p>	<p>CHOPIN, 2nd Floor 10:30am - 12:00pm</p>
<p>Session Chair Rita Teutonico</p>	<p>Session Chair Andrés Aninat</p>
<p>A Systematic Review of Wall Insulation Retrofit Guidelines and Practices in Historic Buildings in North America</p> <p>Presenter Daniel Castele</p>	<p>Collaborative Diagnosis and Intervention for the Conservation of Earthen Architectural Heritage in the Andean Highlands (Jujuy, Argentina)</p> <p>Presenter Jorge Tomasi</p>
<p>Emergence of Synthetic Binders and Pigments in Building Materials and Their Identification Using the Example of Two Ukrainian Settlement Vernacular Wood Houses in East-Central Alberta</p> <p>Presenter Anna Magdalena Hubmann</p>	<p>Indoor Environmental Quality and Energy in Built Heritage: Holistic Retrofit Performance Prediction Methodology</p> <p>Presenter Adrian J. Soble</p>
<p>Flood Vulnerability Assessment and Visualization for Historic Coastal Communities: Cedar Key, Florida, and Nantucket, Massachusetts</p> <p>Presenters Sujin Kim Morris Hylton</p>	<p>Resilience and Sustainability of Heritage Buildings in Argentina: The Refuncionalizacion as a Support</p> <p>Presenters Beatriz S. Garzón Amalita Fernández</p>
<p>The Effects of Casein Protein Additive in Historic Lime Mortar</p> <p>Presenter Kristian Falkjar</p>	<p>Temporary Use: A Conservation Strategy for Historic Buildings in Vacancy In the Colonial City of Santo Domingo, The Dominican Republic</p> <p>Presenter Danae Peguero Bueno</p>

<p>Track 3 Conservation of Modern and Post-Modern Heritage</p> <p>CS3.1 Miami Marine Stadium: Preserving a Modern Concrete Icon</p>	<p>Track 4 Diversity, Population Change, and Gentrification in the Preservation Dialogue</p> <p>CS4.1 Social and Economic Impacts of Preservation</p>
<p>VERSAILLES, 2nd Floor 10:30am - 12:00pm</p>	<p>BISCAYNE, 2nd Floor 10:30am - 12:00pm</p>
<p>Session Chair Rosa Lowinger</p>	<p>Session Chair Frank Sanchis</p>
<p>Miami Marine Stadium: Preserving a Modern Concrete Icon</p> <p>Presenters Hilario Candela Paul Gaudette Richard Heisenbottle Deborah Slaton</p>	<p>The Causality of Preservation and Gentrification: A Case Study</p> <p>Presenter Tiffani Simple</p>
	<p>Linking Public Health Issues with Heritage and Conservation</p> <p>Presenter Bryan Orthel</p>
	<p>Accessibility Improvements to Historic Structures</p> <p>Presenter Amy Gilbertson</p>
	<p>Gentrification and Preservation: Does One Follow the Other?</p> <p>Presenter Caroline Wilson</p>

PAPER SESSIONS

<p>Track 1 Effects of Climate Change in Warm Weather Coastal Regions</p> <p>CS1.2 Zero Net Carbon Collaborative for Existing and Historic Buildings (ZNCC)</p>	<p>Track 2 Sustainability and Conservation of Built Heritage in the Americas</p> <p>CS2.2 Conservation Management Planning Strategies and Building Resiliency for Colonial Historic Centers</p>
<p>BRICKELL, 1st Floor 3:00pm - 4:30pm</p>	<p>CHOPIN, 2nd Floor 3:00pm - 4:30pm</p>
<p>Session Chair Carl Elefante</p>	<p>Session Chair Annabelle Claire Radcliffe-Trenner</p>
<p>Building Reuse – Why Reusing and Decarbonizing Existing Buildings is a Critical Climate Action Strategy.</p> <p>Presenter Larry L. Strain</p>	<p>Condition Assessment of Timber in Himalayan Architecture: Case of Mrikula Devi Temple</p> <p>Presenter Maanvi Chawla</p>
<p>In Situ U-Value Monitoring of Historic Building Walls in Cincinnati’s Over-the-Rhine Neighborhood</p> <p>Presenter Miriam Martinez</p>	<p>Evaluation of Comparative Repair Methods for Stone</p> <p>Presenter Wei Luo</p>
<p>Leveraging the Historic Built Environment to Meet Carbon Reduction Targets: a Balancing Act of Embodied Carbon, Energy Retrofits, and Conservation</p> <p>Presenter Lori Ferriss</p>	<p>Heritage Clay Brick Hygrothermal Material Properties Archive and Insights</p> <p>Presenter Randy Van Straaten</p>
<p>The Role of the Historic Environment and Achieving the Decarbonization Objectives of the Paris Agreement: An Overview</p> <p>Presenter Andrew S. Potts Sanskriti Singh</p>	<p>Resurrecting Historic Graveyards in Jamaica</p> <p>Presenter Mary A. Jablonski</p>

<p>Track 3 Conservation of Modern and Post-Modern Heritage</p> <p>CS3.2 Modern Urban Plazas, Monuments, and Public Spaces</p>	<p>Track 4 Diversity, Population Change, and Gentrification in the Preservation Dialogue</p> <p>CS4.2 Participation and Public Engagement</p>
<p>VERSAILLES, 2nd Floor 3:00pm - 4:30pm</p>	<p>BISCAYNE, 2nd Floor 3:00pm - 4:30pm</p>
<p>Session Chair Pamela Jerome</p>	<p>Session Chair Ethan J. Boote</p>
<p>Heritage Agencies and the Preservation of Brazilian Modern Masterpieces</p> <p>Presenter Carlos Eduardo Comas</p>	<p>Beyond Aesthetics: Social Outcomes of Adaptive Reuse</p> <p>Presenter Allison Fricke</p>
<p>Preservation Moon: Defining and Preserving the Cultural Landscape of Tranquility Base</p> <p>Presenter Karen Kincaid Brady</p>	<p>Chicago's Pilsen Historic District: Immigration, Ethnic Succession, Political Expression & Public Art, Gentrification, and Preservation</p> <p>Presenter Andrea Terry</p>
<p>The Future of a Modern Atlas: Addressing an Iconic Mixed-use Modern Building in the Context of a World Heritage Historic City Center in Lima, Peru</p> <p>Presenter Rosabella Alvarez-Calderon David Fixler</p>	<p>The Act of "Talka" in Historic Preservation Discourse in Contemporary Latvia</p> <p>Presenter Katarzyna Burzynska</p>
<p>The School of Art in La Havana: An Organic Architectural Complex</p> <p>Presenter Andrea Griletto</p>	<p>Toward Inclusion in Preservation: Reconciling Policy, Practice, and Public Perceptions</p> <p>Presenter Erica Avram</p>

PAPER SESSIONS

<p>Track 1 Effects of Climate Change in Warm Weather Coastal Regions</p> <p>CS1.3 Selected Case Studies and Approaches in Climate-Related Resiliency</p>	<p>Track 2 Sustainability and Conservation of Built Heritage in the Americas</p> <p>CS2.3 Stewardship of Pre-colonial Indigenous Sites Across the Americas</p>
<p>BRICKELL, 1st Floor 10:30am - 12:00pm</p>	<p>CHOPIN, 2nd Floor 10:30am - 12:00pm</p>
<p>Session Chair Sonia Chao</p>	<p>Session Chair Jeanne Marie Teutonico</p>
<p>Moveable and Immoveable Heritage in the Face of Climate Change: Collaborative Education Strategies for Buildings and Collections</p> <p>Presenter Jessica Unger</p>	<p>Performance Evaluation of Amended Earthen Mortars at Wupatki National Monument</p> <p>Presenter Caroline P. Dickensheets</p>
<p>Subverting the Dominant Paradigm: Cultivating Nontraditional Preservation Partners and Adapting Existing Hazard Mitigation Practices for Preservation</p> <p>Presenter Jennifer Sparenberg</p>	<p>A Framework for Risk and Vulnerability Assessment for Traditional Sites in the American Southwest</p> <p>Presenter Evan Oskierko-Jeznacki</p>
<p>The Effect of Climate Change on the Preservation Efforts for Bunce Island Slave Castle in Sierra Leone</p> <p>Presenter Melbourne A. Garbe</p>	<p>The Implementation of Seismic Retrofitting Techniques Using Local Materials and Expertise at the Church of Santiago Apóstol of Kuñotambo in Peru</p> <p>Presenter Elena Macchioni Juan Carlos Mellado</p>
<p>Weathering the Storm: Coastal Cultural Landscapes in an Era of Climate Change</p> <p>Presenter Deborah Slaton</p>	<p>A Tale of Two City Churches: Adaptation by Expansion at the Church of Santa Lucia in Santiago de Cuba; and Adaptation by Contraction at the Christ Fellowship Church in Downtown Miami</p> <p>Presenter Ricardo Lopez</p>

SATURDAY, 10:30am - 12:00pm

<p>Track 3 Conservation of Modern and Post-Modern Heritage</p> <p>CS3.3 Concrete and Brutalism</p>	<p>Track 4 Diversity, Population Change, and Gentrification in the Preservation Dialogue</p> <p>CS4.3 Architectural and Historical Underrepresentation</p>
<p>VERSAILLES, 2nd Floor 10:30am - 12:00pm</p>	<p>BISCAYNE, 2nd Floor 10:30am - 12:00pm</p>
<p>Session Chair Carmen Guerrero</p>	<p>Session Chair Leila Hamroun-Yazid</p>
<p>Emerging Technology for Building Diagnostics</p> <p>Presenter Michael Schuller</p>	<p>Forgotten Stories: Chinese-American Exclusion and Built Legacy in Small Town America</p> <p>Presenter Nicholas Vann</p>
<p>Sidi Harazem: Conserving Moroccan Modernism</p> <p>Presenter Eytan M. Solomon</p>	<p>Heritage Making in Post-Industrial Landscapes: Legitimizing Working-Class Narratives in Lota, Chile</p> <p>Presenter Magdalena Novoa</p>
<p>The Power Behind Architecture. Modern Buildings Used as Strategy to Convey a Political Ideology in the Caribbean</p> <p>Presenter Virginia Flores Sasso Gabriela Fernandez</p>	<p>Off the Map: Spatializing Access to Memory in Beitunia, Palestine</p> <p>Presenter Adam S. Lubitz</p>
<p>Use of Microclimate Simulation to Assess the Environmental Vulnerabilities of Modern Heritage</p> <p>Presenter Daniela R. Werneck</p>	<p>Preserving LGBT Sites: The New York City LGBT Historic Sites Project and the Creation of a More Inclusive Preservation Canon</p> <p>Presenter Andrew S. Dolkart</p>

PAPER SESSIONS

<p align="center">Track 1 Effects of Climate Change in Warm Weather Coastal Regions</p> <p align="center">CS1.4 Cultural Maintenance and Climate Change</p>	<p align="center">Track 2 Sustainability and Conservation of Built Heritage in the Americas</p> <p align="center">CS2.4 Materiality, Craftsmanship, and Conservation of Vernacular Buildings in the Caribbean and Americas</p>
<p align="center">BRICKELL, 1st Floor 1:30pm - 3:00pm</p>	<p align="center">CHOPIN, 2nd Floor 1:30pm - 3:00pm</p>
<p align="center">Session Chair Nancy Rankin</p>	<p align="center">Session Chair Olsen Jean Julien</p>
<p align="center">Concrete Material Degradation in Tropical and Urban Climate</p> <p align="center">Presenter Irene Matteini</p>	<p align="center">Before the "Dilbit" Disaster: Developing an Oil Spill Response Protocol for Historic Buildings</p> <p align="center">Presenter Elizabeth C. Salmon</p>
<p align="center">Flooding Resiliency of Traditional Materials</p> <p align="center">Presenter Jenny Parker</p>	<p align="center">Preserving Rural Heritage: Learning From Chile's 2010 Rebuilding Process</p> <p align="center">Presenter Maria Munoz</p>
<p align="center">Gullah/Geechee and How de Wata da Move We: A Cultural Heritage Model for Coastal Community Sustainability</p> <p align="center">Presenter Queen Quet Marquette L. Goodwine Dan Rizza</p>	<p align="center">Pirenopolis Mother Church Restoration: a new paradigm in Brazilian Earth Architecture Preservation</p> <p align="center">Presenter Marco Rezende</p>
<p align="center">Residential Heritage: Deep Energy Retrofit Analysis Case Study and Methodolog</p> <p align="center">Presenter Larissa R. Ide</p>	<p align="center">Analyzing Digital Photogrammetry for Heritage Preservation</p> <p align="center">Presenter Rob Kesack</p>

SATURDAY 1:30pm - 3:00pm

<p align="center">Track 3 Conservation of Modern and Post-Modern Heritage</p> <p align="center">CS3.4 Ordinary Everyday Modernism (OEM) in Miami, The Caribbean and the Americas</p>	<p align="center">Track 4 Diversity, Population Change, and Gentrification in the Preservation Dialogue</p> <p align="center">CS4.4 Miami and Caribbean Case Studies</p>
<p align="center">VERSAILLES, 2nd Floor 1:30pm - 3:00pm</p>	<p align="center">BISCAYNE, 2nd Floor 1:30pm - 3:00pm</p>
<p align="center">Session Chair David Fixler</p>	<p align="center">Session Chair Angel Ayón</p>
<p align="center">Creating a Digital Record of Mid-Century Modern Architecture: Documentation of the Teague Research Center at Texas A&M University</p> <p align="center">Presenter Ben Baaske</p>	<p align="center">Approaching Preservation in the Bahamas with the Voice of The Community; Preserving the Character, Charm, and Culture of Harbor Island, a Beloved Home to Many</p> <p align="center">Presenter Ricardo Lopez</p>
<p align="center">Historic Preservation of the Casa de Estudios para Artistas (Study House for Artists), Antonio Bonet, Buenos, Aires, Argentina, 1939</p> <p align="center">Presenter Pablo Guiraldes M. Gabriela Dunes</p>	<p align="center">Chicago's Pilsen Historic District: Immigration, EtBuilding the "Artisan Army": Empowering the Next Generation of Craftspeople Through Hands-On Workshops</p> <p align="center">Presenter Katie Totman</p>
<p align="center">Preservation of EIFS - A Modern Building Enclosure System: Lessons Learned</p> <p align="center">Presenter Vanessa R. Singh</p>	<p align="center">Remembering Puerto Rico: A Post-Disaster Understanding of Historic Preservation</p> <p align="center">Presenter Nadya K. Nenadich</p>
<p align="center">Preserving Ely Jacques Kahn's Bricken Casino Building</p> <p align="center">Presenter Vishal M. Joshi</p>	<p align="center">Screen Block and the Mid-Century Built Environment of Florida</p> <p align="center">Presenter Kristine Ziedina</p>

PAPER SESSIONS

<p>Track 1 Effects of Climate Change in Warm Weather Coastal Regions</p> <p>CS1.5 Adaption Planning for Sustainability in Historic Coastal Communities</p>	<p>Track 2 Sustainability and Conservation of Built Heritage in the Americas</p> <p>CS2.5 Building Resiliency in Pre-colonial, Maritime and Post-colonial Heritage Sites Affected by Climate Change, Part 2</p>
<p>BRICKELL, 1st Floor 3:30pm - 5:15pm</p>	<p>CHOPIN, 2nd Floor 3:30pm - 5:15pm</p>
<p>Session Chair Matthew K. Haberling</p>	<p>Session Chair Kyle Normandin</p>
<p>Aligning Flood Mitigation and Preservation Strategies for Historic Buildings</p> <p>Presenter Nicholas Floyd</p>	<p>24 Sussex Drive: A Zero Net Carbon Proposal to Revitalize the Residence of Canada's Prime Minister</p> <p>Presenter Carly Farmer</p>
<p>Green Space Conversion: Strategies for Sustainable Design in Modern and Historic Roofs</p> <p>Presenter Kenrick J. Hartman</p>	<p>Addressing Flood Risks to Historic Sites Caused by Man-Made Changes to Watersheds</p> <p>Presenter Adam Rush</p>
<p>Modern Heritage and Bio-Environmental Adaptation: The Sanitary Architecture's Case in Tucumán.</p> <p>Presenter Beatriz S. Garzón Amalita Fernández</p>	<p>Cooper Molera Adobe, Monterey California: When a Preserved Site Needs to be Preserved Again</p> <p>Presenter Naomi Miroglio</p>
<p>Preservation in Hot Water: Climate Change and Third System Forts of Louisiana</p> <p>Presenter Lindsey Walsworth</p>	<p>Retrofitting of Concrete Encased Beam-Column Connection of an Old Historic Building Using Fiber Reinforced Polymer (FRP)</p> <p>Presenter Nitisha Parajuli</p>
	<p>The Conservative Restoration and Conversion Project of the Mercato Coperto in Ravenna: New Urban Languages, Innovative Intervention Methods and Sustainable Approaches Within the Context of Modern Architecture</p> <p>Presenter Anna Claudia Cicognani</p>

SATURDAY 3:30pm - 5:15pm

<p>Track 3 Conservation of Modern and Post-Modern Heritage</p> <p>CS3.5 Art Postwar Decorative Finishes in the Caribbean and the Americas</p>	<p>Track 4 Diversity, Population Change, and Gentrification in the Preservation Dialogue</p> <p>CS4.5 Preservation Enhancing Social Equity: Case Studies From the Field</p>
<p>VERSAILLES, 2nd Floor 3:30pm - 5:15pm</p>	<p>BISCAYNE, 2nd Floor 3:30pm - 5:15pm</p>
<p>Session Chair Helen M. Thomas-Haney</p>	<p>Session Chair Natalie Feinberg-Lopez</p>
<p>Moving the Immovable: Logistical Challenges in the Relocation of Monumental Architectural Artworks</p> <p>Presenter Kelly Ciociola Christina Varvi</p>	<p>Art, Equity & Diversity Expanding Preservation's Horizon</p> <p>Presenter Walter Sedovic</p>
<p>Two Cultural Patrimonies at Stake: The Conservation of a Modern Fresco Mural in a Colonial Building in the Dominican Republic</p> <p>Presenter Viviana Dominguez Hilda Abreu de Utermohlen</p>	<p>Immigrant Heritage? Place Making and Preservation by the South-Asian Diaspora in Houston</p> <p>Presenter Priya Jain</p>
<p>Saving Streamline Moderne: Conservation of Stone and Gold-Glass Mosaic Facades of the Saban (former May Co.) Building at the Academy of Motion Pictures, Los Angeles</p> <p>Presenter John A. Fidler</p>	<p>Mitigating Gentrification: A Holistic Approach to the Preservation and Revitalization of Historic Neighborhoods</p> <p>Presenter Sabrina L. Cox</p>
<p>Soft Reds and Hard Tans: Creating an Index of Vulnerability for Nineteenth-Century New Orleans Brick</p> <p>Presenter Justin N. Lynch</p>	<p>Sanitizing the Stoop: Gentrification, Preservation, and Lost Public Space in Harlem</p> <p>Presenter Elizabeth C. Ponder</p>

2019 STUDENT SCHOLARS

The APT Scholarship and Outreach Committee selected the following students to receive an APT Miami Scholarship, which includes conference registration, one-year membership to APT, the opportunity to present during a paper session, as well as mentoring from a member of the College of Fellows. Please welcome this year's Student Scholars!

Ben Baaske
Center for Heritage Conservation
Texas A&M University
Advisor: Kevin Glowacki
Mentor: Lonnie Hovey

Daniel Castele
University of Cincinnati
Advisor: Amanda Webb
Mentor: Kyle Normandin

Caroline Dickensheets
University of Pennsylvania
Advisor: Frank Matero
Mentor: Hugh Miller

Kristian Falkjar
Carleton University
Advisor: Jeffrey Erochko
Mentor: Melvyn Green

Allison Fricke
Columbia University
Advisor: Erica Avrami
Mentor: Caroline Alderson

Anna Magdalena Hubmann
University of Alberta
Advisor: Thomas Stachel
Mentor: Ron Anthony

Larissa Ide
Carleton University
Advisor: Mario Santana Quintero
Mentor: Ilene Tyler

Rob Kesack
Columbia University
Advisor: Norman Weiss
Mentor: Barbara Campagna

Karen Kincaid Brady
The University of Texas at Austin
Advisor: Michael Holleran
Mentor: Deborah Slaton

Wei (Melissa) Luo
University of Pennsylvania School of Design
Advisor: Roy Ingraffia
Mentor: David Fixler

Justin Lynch
University of Pennsylvania
Advisor: Frank Matero
Mentor: Joan Berkowitz

Miriam Martinez
University of Cincinnati
Advisor: Amanda Webb
Mentor: Pamela Jerome

Magdalena Novoa
School of Architecture
University of Texas at Austin
Advisor: Michael Holleran
Mentor: Michael Tomlan

Nitisha Parajuli
Southern Illinois University Edwardsville
Advisor: Brad Cross
Mentor: Michael Schuller

Adrian Soble
Carleton University
Advisor: William O'Brien
Mentor: Anne Weber

Daniela Werneck
University of Brasilia
Advisor: Marta Adriana Romero
Mentor: Theo Prudon

Caroline Wilson
Savannah College of Art and Design
Advisor: Sabrina Cox
Mentor: Nancy McCoy

Kristine Ziedina
University of Florida
Advisor: Morris Hylton III
Mentor: Thomas Jester

Student Scholarship and Outreach Committee

Elaine Shapiro
Kara Dotter
Amy Jagaczweski
Sue Ann Pemberton

Christina Wallace
Andreea Hamilton
Vishal Joshi
Payal Vora

Individuals and companies that have contributed to the Student Scholar Program are listed on page 5.

STUDENT ENGINEERING COMPETITION

The Design Build Competition provides real life preservation-based challenges to students, encouraging teams to think outside the box. Finalists are invited to the conference to compete in building and testing an unreinforced arch of their design, and to address a set of preservation problems. Conference attendees are encouraged to dialogue with students and discuss what it means to do what we do.

2019 Student Engineering Competition Finalists

Finalists (in alphabetical order)

Ball State University

Kyle Antony-Petter
Melissa Blake
Caitlin Liskey
Brianna Minnich
Kai Shirey
Johnathan Spodek

Carleton University

Yasmin Anderson
Kyra Cooper
Yifang Liu
Jamie Marrs
Travis Murison
Wanda Trinh
Welsey Wilson

Columbia University

Sreya Chakraborty
Erin Murphy
Gwen Stricker
Micah Tichenor

University of Nebraska-Lincoln

Ahmad Shoaib Amiri
Morgan Davis
Tess McCabe
Edward McNamara
Tunc Deniz Uludag

Willowbank School of the Restorative Arts

Emily Cheese
Lisa Christie
Graham Forster
Meghan Lenz
Chris Riou
Antiy-Demian Savov

Student Engineering Program Sponsors

This program was made possible through the countless hours of the Preservation Engineering Technical Committee as well as the following sponsoring companies and individuals. Thank you all!

GRANITE

MARBLE

SANDSTONE



HERITAGE STANDING INC.
ENGINEERING FOR OLD BUILDINGS



International Masonry Institute

Susannah J. Rast & John E. Dumsick

Tim Crowe

BRICK

MORTAR



Erin Fisher

Gina Crevello

Sarah Van Domelen

Terry Mominee

Cristina Radu

Adam Rush

Amy Woods

Preservation Engineering Technical Committee Co-Chairs

Timothy Crowe

Tom Morrison

Amy Woods

John Dam

John Dumsick

Tim Crowe

GETTY TRAVEL GRANT RECIPIENTS



The Getty Foundation

The Getty Connecting Professionals/Sharing Expertise Grant provides funding by invitation only to professional organizations that serve museums and the disciplines of art history and conservation. These grants have primarily focused on supporting the attendance of colleagues from countries with emerging economies at large-scale international forums for professional exchange.

As a result of the grants, professionals from countries that are often underrepresented have the opportunity to connect with international experts working in their fields, enhance their practical and theoretical knowledge, and take back lessons learned to share with their local communities (www.getty.edu/foundation/initiatives/current/profdevelopment). Through this grant, the following preservation professionals from Latin America and the Caribbean were able to travel to this year's Conference!

Luciana Rocha Feres
Federal University of Minas Gerais/ Catholic
University of Minas Gerais
Brazil

Danae Peguero
Federal University of Minas Gerais/ Catholic
University of Minas Gerais
Brazil

Beatriz Garzon
FAU UNT - CONICET
Argentina

Jorge Tomasi
CONICET / Universidad Nacional de Jujuy
Argentina

Olsen Jean Julien
Phenixience
Haiti

André Aninat
Fundación Altiplano Chile
Chile

Rosabella Alvarez-Calderon
Department of Architecture, Pontificia
Universidad Catolica del Peru
Peru

Germaine Joseph
The Saint Lucia National Trust
Saint Lucia

Virginia Flores Sasso
Pontificia Universidad Católica
Dominican Republic

Gabriela Fernandez
Arquitrail
Dominican Republic

Enrique Segovia Molinas
Escuela de Ingenieria Municipal
Mexico

Pablo J Guiraldes
Ministry for the Environment and Public Space,
City Government of Buenos Aires
Argentina

Marco Rezende
Architecture - Universidade Federal de Minas
Gerais
Brazil

Nadya K. Nenadich
United States

Carlos Eduardo Comas
UFRGS-Universidade Federal
do Rio Grande do Sul
Brazil

Andres Gaviria
Pontificia Universidad Javeriana
Columbia

Renata Campiotto
School of Architecture and Urbanism of the
University of São Paulo
Brazil

Laura Alecrim Farias
Wyden Educational UniFBV - UniFAVIP
Brazil

EXHIBITORS

Abatron, Inc.

www.abatron.com • (262) 653-2000

Abatron is a leading manufacturer of specialty restoration products with deep roots in historic preservation. We offer epoxy repair products for wood, concrete & metal as well as specialty plaster repair materials.

Booth 26

APT European Chapter

www.apteurope.org

The European Chapter aims to advance appropriate traditional and new technologies to care for, protect and promote the longevity of the built environment and to cultivate the exchange of knowledge throughout the European Community.

Booth 29

Atlas Preservation Inc

<https://atlaspreservation.com>

Consultation, training and conservation services for monument and building restoration. Based on personal hands-on experience in stone installation, restoration and preservation since 1986, our inventory & product selection options are extensive and unique.

Booth 9

BEECK Mineral Paints

www.beeckmineralpaints.com

BEECK Mineral Paints, a US owned company, specializing in high quality affordable mineral silicate paints for historic structures. Over 120 years of experience with historic projects makes BEECK the best solution to help assure a trouble-free project.

Booth 22

Bonstone Materials Corporation

www.bonstone.com • (262) 363-9877

If your application involves re-attaching, anchoring, "Dutchman repairs", crack repair, and patching we will work with you in preserving as much material as possible. Our unique product offering will enable you to clean your substrate, repair when needed.

Booth 3

Conproco

conproco.com

Since 1975, we've been developing premium quality concrete and masonry products by combining advanced material science with field proven performance.

Booth 47

Conrad Schmitt Studios, Inc.

www.conradschmitt.com

Conrad Schmitt Studios creates and restores interiors and fine works of art for buildings of architectural, historical and religious significance. CSS is also recognized for outstanding craftsmanship in the creation, conservation and restoration of stained glass.

Booth 6

Copperbridge

<http://copperbridge.org/>

Copperbridge Foundation (CBF) is a non-profit organization with a mission to promote cultural and educational exchange through the medium of artistic expression. CBF strives to ensure that all of our spaces and events are accessible.

Booth 15

Creadditive

www.creadditive.ca

Our projects are carried out by our strong technical team, recognized across Canada for its knowledge and contributions to new 3D scanning and manufacturing techniques and our visionary management team.

Booth 1

D/2 Biological Solution

www.d2bio.com • (917) 693-7441

D/2 Biological Solution is a biodegradable, nontoxic liquid that removes stains from mold, algae, mildew, lichens and air pollutants. It is effective on marble, granite, limestone, brownstone, travertine, masonry, terra cotta, concrete, stucco, wood, and other architectural surfaces.

Booth 25

Echem Consultants LLC

<http://e2chem.com>

Echem Consultants LLC (WBE, DBE, & SBE certified) is a material science consultancy whose primary focus is understanding material durability of the built environment. Echem assists with diagnostics, analysis and repair of existing structures and advice on material selection, design and construction monitoring for new construction.

Booth 5

Eclipse Surface Technologies

<http://Eclipseblast.com>

The ECO-FLEX product line, designed and engineered by Eclipse Surface Technologies, offers lightweight, low pressure, micro-abrasion and restoration equipment for the world of historic preservation.

Booth 20

Edison Coatings, Inc.

www.edisoncoatings.com • (860) 747-2220

Since 1981, Edison Coatings has been developing and manufacturing customized products for stone, masonry and historic concrete restoration: historic mortar and concrete replication mixes, repair mortars, consolidants, admixtures, water repellents, grouts, adhesives, breathable coatings and Natural Cement.

Booth 2

EverGreene Architectural Arts

<https://evergreene.com> • (212) 244-2800

Since 1978, EverGreene Architectural Arts has provided award-winning design and fabrication, conservation and restoration services for many of the world's most significant buildings and objects. In 2018 we expanded our historic conservation practice by acquiring Conservation Solutions.

Booth 31

G.C. Laser Systems Inc.

www.gclasers.com

Our unique patented laser systems were originally designed for art and architecture conservation to offer unmatched precision, control, and efficiency for cleaning historic surfaces. Our environmentally friendly technology has been specifically designed to safely clean a variety of surfaces without damaging the substrate.

Booth 23

GeoSonics/Vibra-Tech

www.geosonicsvibratech.com

GeoSonics/Vibra-Tech has the tools and experience to help you manage your construction risk. Our Remote Monitoring Technology brings the field to you whether you need vibration, noise, dust, geotechnical or environmental monitoring.

Booth 43

Gladding, McBean

www.gladdingmcbean.com • (916) 644-9385

Architectural terra cotta manufacturer

Booth 33

Historic Plaster Conservation Services

historicplaster.com

Historic Plaster Conservation Services USA (HPCS) focuses on the very specific field of architectural plaster conservation.

Booth 48

EXHIBITORS

IBIX North America

www.IBIXUSA.COM • (727) 322-4611

IBIX North America, Surface Technologies LLC. is a Florida based company in conjunction with our European Partners, IBIX SRL, Members of Assorestauro (Historic Preservation Society of Italy), are committed to supplying the most technologically advanced MICRO-Abrasion, soft cleaning systems for Preservation of Buildings, Monuments and Artifacts in the World.

Booth 28

Continuous product innovation ensures development of the most appropriate products for the global marketplace. As a 200 year old company, Pilkington is synonymous with Flat Glass manufacturing excellence and innovation.

John Canning & Co., Ltd.

JohnCanningCo.com • (203) 272-9868

John Canning & Co is the leading contractor in architectural finishes for building restoration. Our work with plaster, decorative painting, art conservation, and wood and stone restoration can be seen in some of the country's most iconic buildings and national landmarks. We emphasize the importance of craftsmanship and authenticity.

Booth 19

Polar Clean

www.polarclean.com

Polar Clean identifies client needs and potential risks in order to engineer a better solution that meets or exceeds all of the client's needs, while reducing potential risk factors.

Booth 17

KEIM Mineral Coatings

www.keim-usa.com • 704-588-4811

The inventor of mineral silicate paints, Keim is the worldwide leader in mineral silicate solutions for masonry restoration. Offering a premium level of support, ensuring your projects are flawless, and providing a full line of mineral and lime finishes, stains and repairs for any historic masonry restoration project.

Booth 7

PROSOCO

www.prosoco.com • (785) 830-7325

A manufacturer of cleaners, protective treatments, and consolidation treatments for the sustainable restoration and preservation of historic masonry interiors and exteriors. Also makes products to clean and protect new masonry.

Booth 18

Langan Engineering and Environmental Services

www.langan.com

Langan provides exceptional surveying that raises the bar of existing conditions data acquisition. Utilizing a range of mapping techniques and state-of-the-art equipment - the result are survey-grade deliverables that seamlessly integrate with project needs. Our highly accurate and efficient surveying process helps keep projects on schedule and within budget.

Booth 14

Pullman SST Inc

www.pullman-services.com

PULLMAN, a Structural Group company, integrates technology-driven engineered solutions into its industry-leading contracting services. Our capabilities include specialty design-build services for new and existing structures, as well as a wide range of specialty repair and maintenance services.

Booth 13

Layer

<https://layer.team>

Layer is a flexible data management app that encourages team collaboration and integrates directly with Revit. Layer makes it easy for architects and engineers to capture, organize, and share project data, files, notes, and tasks from one intuitive workspace that organizes everything by its building context.

Booth 42

Quintek Corporation

www.quintek.net

The Quintek Corporation is committed to provide safe cleaning technology to preserve our historic structures and the environment.

Booth 44

Remmers BVBA

<http://www.remmers.be>

Remmers is a worldwide manufacturer of chemical building products for the restoration field, i.a. known for Arte Mundit® (interior cleaning). For exterior cleaning, they now introduce an innovative product called Clean Galena. It not only cleans the surface thoroughly/it not only peels off the dirt but also encapsulates lead.

Booth 16

LimeWorks.us

www.limeworks.us • (215) 536-6706

Manufacturer, educator, and mentor in the use of breathable lime mortars, stuccos, plasters, and paints used for historic masonry restoration and sustainable buildings. Our products help process water away from building interiors which extends their service life.

Booth 27

Re-View Windows, Inc.

www.reviewwindows.com

A full service historic window company that specializes in everything associated with the window opening including historic wood window manufacturing, wood window restoration, steel window restoration, lead paint abatement, window installation, window finishing, hardware restoration, and insulated glass conversion.

Booth 45

Master of Plaster Finishing Systems

www.masterofplaster.com • (803) 530-8232

From our founding Restoration Plaster used to restore and preserve the most prestigious historic structures, to our Venetian Plasters that create the most stunning interiors, our plasters serve as a palette for the most creative and discerning clients.

Booth 32

Re.USA Project

www.apteurope.org/re.usa

The project intends to promote the Italian companies belonging to sectors of architectural restoration, sustainability and energy efficiency of the historical and modern buildings in the United States.

Booths 38, 39,40,41

Pilkington North America

www.pilkington.com • (419) 247-3994

A leading global glass manufacturer, the NSG group provides the broadest range of glass products available in the world today.

Booth 37

RLA Conservation of Art + Architecture

www.rlaconservation.com • (323) 377-8425

RLA is a team of professionally trained conservators and artisans specializing in the care of sculpture, historic architecture, and artifacts. We provide emergency response services, conditions assessments, stabilization, conservation, maintenance, repair, restoration and long-term management of cultural heritage objects and structures.

Booth 15

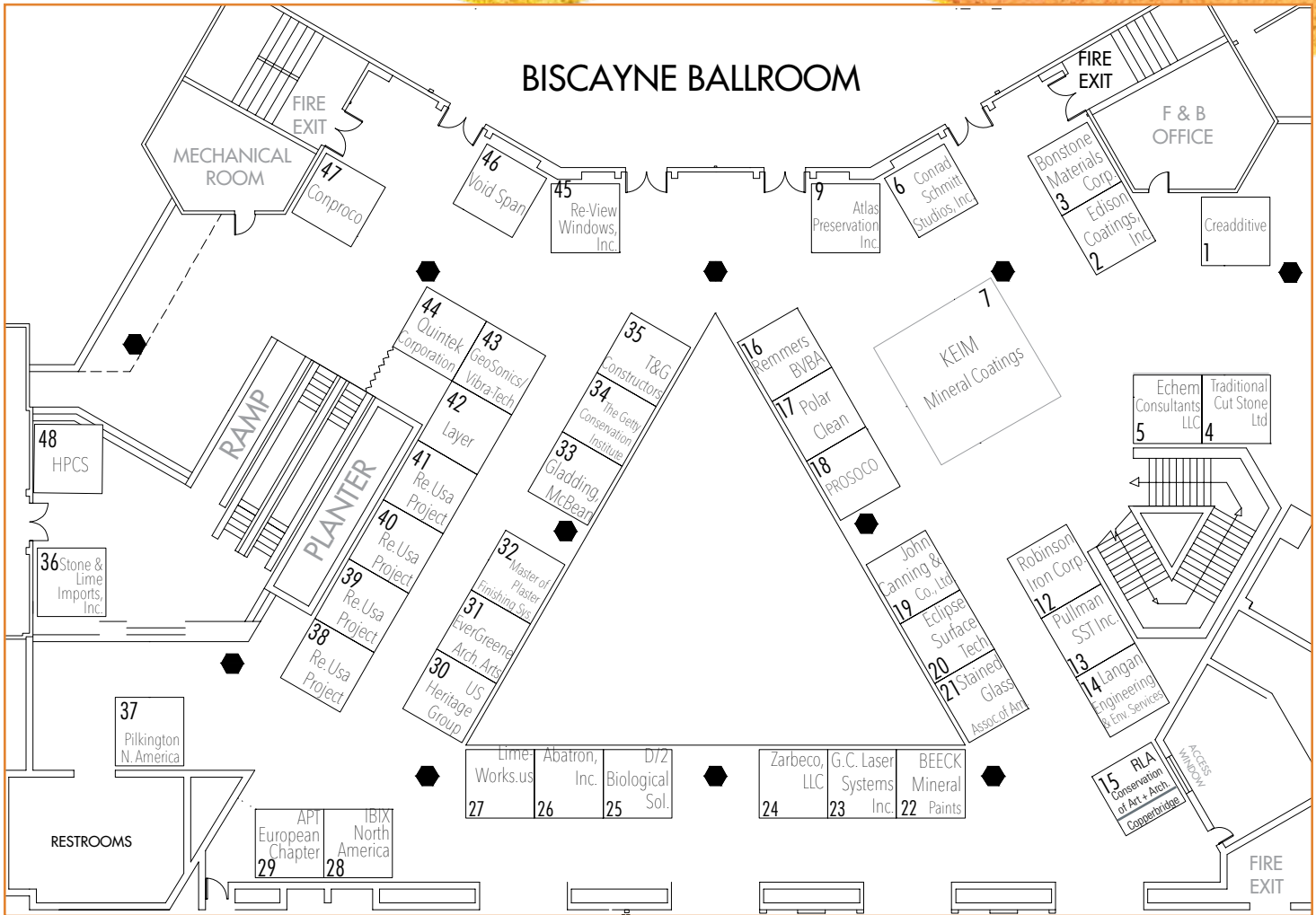

Robinson Iron Corporation
www.robinsoniron.com • (256) 329-8486
 Ornamental metals restoration and fabrication.

Stained Glass Association of America
<https://stainedglass.org>
 A professional trade association for architectural stained and decorative art glass artists and studios. The SGAA actively works for the betterment of the craft of stained and architectural art glass through programs to benefit members of the SGAA and our clients.

Stone & Lime Imports, Inc.
www.stoneandlime.com
 Stone & Lime, a masonry restoration contractor, has a long history of working on historic restoration projects along the east coast spanning from Florida to Maine. We provide masonry restoration consulting services, technical support and training for natural cement applications.

T&G Constructors
www.t-and-g.com
 Our method and scope of services have earned us a reputation for taking your profitability seriously. Through early involvement, creative solutions and reasoned alternatives, we minimize your risks, safeguard your investments and look after your bottom line.

Booth 12 The Getty Conservation Institute
<http://www.getty.edu/conservation>

The Getty Conservation Institute (GCI) works internationally to advance conservation practice in the visual arts - broadly interpreted to include objects, collections, architecture, and sites. The Institute serves the conservation community through scientific research, education and training, field projects, and the dissemination of information.

Traditional Cut Stone Ltd
www.traditionalcutstone.com

With the largest number of classically trained stone carvers in North America, we set the standard for heritage masonry restoration and building preservation, using centuries-old stone carving techniques.

US Heritage Group
<https://usheritage.com>

US Heritage Group offers products and services for masonry restoration projects, from condition assessment, mortar matching and architectural specification to on-site contractor training and custom pre-blended historic restoration product manufacturing. We also offer consulting services to specifiers and installers for traditional masonry preservation projects and sustainable new design.

EXHIBITORS

Void Span

www.voidspan.com

Created in 2011 by a team of engineers, scientists, and preservation practitioners to offer unique, dependable and practical solutions to the frontier of conservation and preservation challenges. VoidSpan holds the only international patents on the Port Anchor, as well as the methods and tying and bonding existing masonry together.

Booth 46

Zarbeco, LLC

www.zarbeco.com

A manufacturer and designer of portable digital microscopes and software. Our multi-spectral microscopes image in white, UV and IR to match pigments, and materials. Video Toolbox PC software captures images, compares, measures, enhances, draws and labels on images.

Booth 24

PRODUCT PAVILION

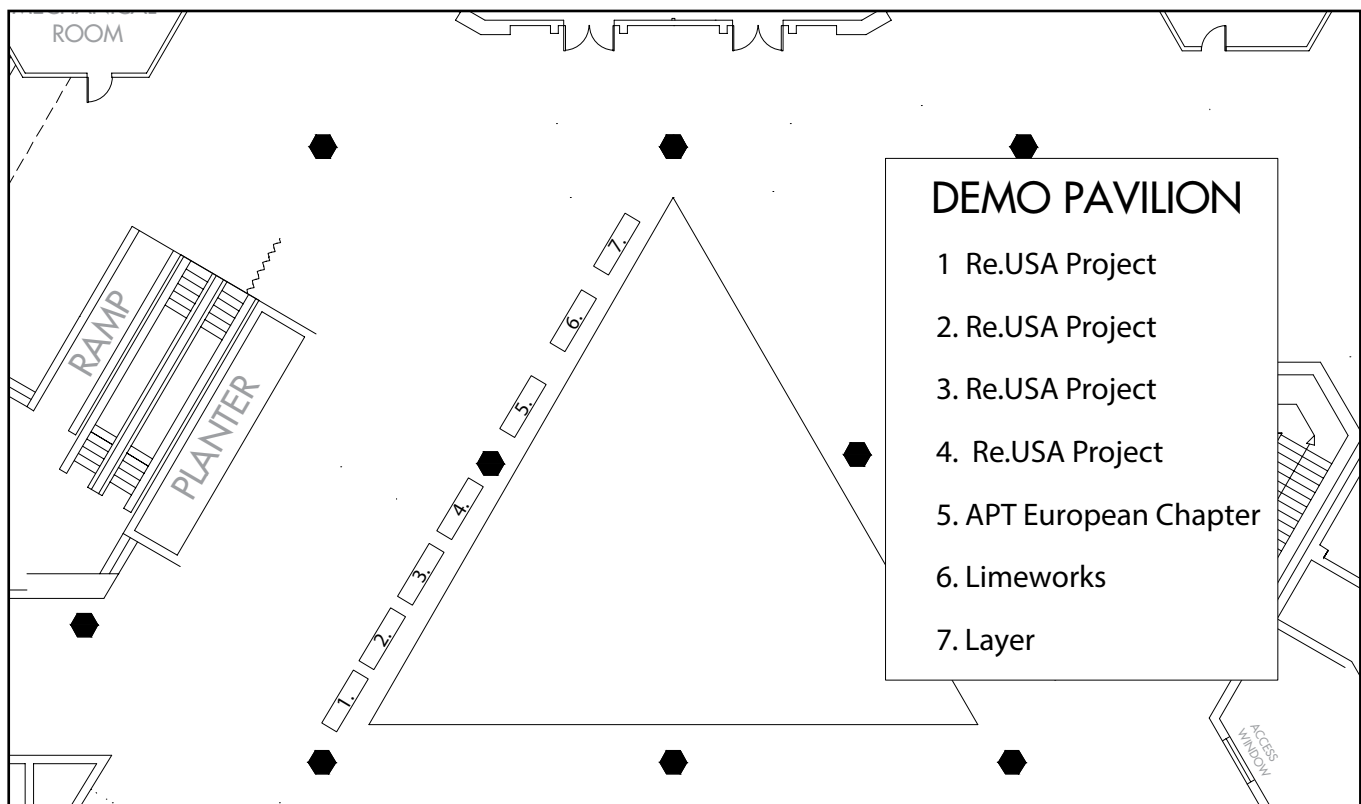

Layer

Table 7

<https://layer.team>

Layer is a flexible data management app that encourages team collaboration and integrates directly with Revit. Layer makes it easy for architects and engineers to capture, organize, and share project data, files, notes, and tasks from one intuitive workspace that organizes everything by its building context.

LimeWorks.us

Table 6

www.limeworks.us • (215) 536-6706

Manufacturer, educator, and mentor in the use of breathable lime mortars, stuccos, plasters, and paints used for historic masonry restoration and sustainable buildings. Our products help process water away from building interiors which extends their service life.

Re.USA Heritage Inside

Tables 1-4

www.apteurope.org/re.usa

The project intends to promote the Italian companies belonging to sectors of architectural restoration, sustainability and energy efficiency of the historical and modern buildings in the United States.

APT European Chapter

Table 5

www.apteurope.org

APT European is a chapter of the Association for Preservation Technology international encompassing European companies and institutions. The main mission is to advance appropriate traditional and new technologies to care for, protect and promote the longevity of the built environment and to cultivate the exchange of knowledge throughout the European Community.

MIAMI PLACES OF INTEREST



GENERAL INFORMATION

Attire: Most events are business casual. Field sessions may combine both indoor and outdoor locations; it is recommended to dress in layers and wear good walking shoes. For the APT Awards Banquet, cocktail attire is recommended, but not mandatory.

Badges: Required at all conference events.

Meals: Your full conference registration includes: Food served at the Exhibit Gala, continental breakfast (Friday-Saturday), lunch (Friday and Saturday), plus refreshment breaks. All other meals are on your own and are a great opportunity to see downtown Miami. Workshop attendee registration includes continental breakfasts and lunch each day they meet. Full day field sessions include lunch only. All field sessions include a reusable water bottle.

Events: Most conference events will take place at the Intercontinental Miami. Workshops and/or field sessions with off-site locations will have transportation provided. Other events taking place off-site will be listed on the Special Events page and transportation to these events will be on your own.

Events with fees: Space permitting, you may still register for a workshop, field sessions and/or purchase special event (SE) tickets at the APT registration desk. Look for the (\$) symbol for any events that require an additional fee.

Guests: Registered guests will receive a badge which needs to be worn during the conference. Guest registration includes the Exhibit Gala and Exhibit Hall, Demo Pavilion, and the opportunity to purchase tickets for all special events (SE). Continental breakfast and lunch (Friday and Saturday), are included.

Lost and Found: Will be located at conference registration at the Intercontinental during regular conference registration hours. All registration hours and locations are listed on the agenda.

Mobile App Assistance: Visit the Conference Resource Desk for assistance or mobile app issues.

Attendee list: A list of conference registrants will be posted in the mobile app.

Have the Conference at your fingertips!

Favorites
Build your personal summary by favoriting presentations, people, and exhibitors.

Note-Taking
Take notes next to each presentations slide and even draw right on the slides!

Share
Share information easily in auto-emails, tweets, and from your personalized summary.

In addition, with the mobile app you can:

- Setting up a personalized schedule
- Download your CE Certificates
- Connect with other attendees
- Explore Miami

How to get started:

1. Download the EventScribe App
 - a. Scan the QR above
 - b. URL Link
 - c. Search for "APT Miami 2019" in your app store
2. Access the App
 - a. Refer to the email sent by Cadmium to login with your email and provided password, OR
 - b. Use the email you used to register for the conference as your Username. Click "Forgot Password" to have your password sent to your email, OR
 - c. Email adam@whitecloudmg.com to have your password reset and sent to you.
3. Set up your profile and schedule;
 - a. Please set up your profile as it will help others to connect and collaborate with you.
 - b. Your registration details ARE NOT synced with this app. You must go through each session and "favorite" them. Your preferred calendar app may be synced with your choices.
4. Process your CE's
 - a. Once complete with your session, you are encouraged to complete your session survey in order to be issued your CE certificate. Please allow up to 60 days to see CEUs appear in your AIA, RCEP or ASLA transcripts.
5. Need help? Visit Adam at the APT Resource desk during regular registration hours.

BECOME A MEMBER TODAY!



The Association for Preservation Technology International (APT) is a multi-disciplinary, membership organization dedicated to promoting the best technology for conserving/preserving historic structures and their settings. APT provides members opportunities for networking and the exchange of ideas.



Member Benefits:

- APT Bulletin, the peer-reviewed journal that is the ultimate source for cutting-edge preservation techniques
- *Communiqué*, our quarterly electronic newsletter
- APT annual conferences, held in cities across North America
- Specialized training and education opportunities
- APT Chapters, offering local networking and information
- An international network of leading preservationists
- Discounts on conferences and publications
- Student scholarships
- Listing in and access to APT online membership directory
- Online access to past issues of the *Bulletin* via JSTOR, a digital archive that enables APT members to search, browse, download, and print full-text PDF versions of articles

APT members include preservationists, architects, engineers, conservators, consultants, contractors, craftspersons, curators, developers, educators, historians, landscape architects, students, technicians, and other persons directly involved in the application of methods and materials to maintain, conserve, and protect historic structures and sites for future use and appreciation.



APTI.ORG

Save the date • Réserver la date

APT & NATIONAL TRUST FOR CANADA
2020 JOINT CONFERENCE
EDMONTON, OCTOBER 3-7

LA CONFÉRENCE CONJOINTE
APT & LA FIDUCIE NATIONALE DU CANADA 2020
EDMONTON, DU 3 AU 7 OCTOBRE

Join us at the APT Annual General Meeting to find out more!
Friday, 1:30pm - Trianon



Photos: Edmonton Tourism



National Trust
for Canada



Fiducie nationale
du Canada

